

AC SCHNITZER

-Fitting Instructions-

Crash Pad

– S1000RR from model 2019–



Parts-No: S700371-F15

General Notes!



AC Schnitzer – S1000RR –

Important Notes!

It is essential to read these installation instructions before starting installation work. AC Schnitzer accepts no liability for damage caused by improper installation!

These installation instructions are intended exclusively for use by authorized AC Schnitzer or BMW dealers. The target group for these installation instructions is in any case specialist personnel trained on BMW vehicles with appropriate specialist knowledge and tools. Knowledge of material properties and standards is assumed!

The crash pads offered by AC Schnitzer provide protection for the frame and add-on parts in the event of "tip-overs" or so-called "slips". Unfortunately, even these components are no guarantee of accidents without consequential damage. It is quite possible, for example, that the crash pads may catch on protruding parts such as curbs, manhole covers, curb stones, etc. in the event of a "skid", curbs, manhole covers, curbs, etc., and give way under the force exerted.

Any resulting consequential damage is the sole responsibility of the person who caused the fall and cannot be claimed from AC Schnitzer. -Please inform your customers about this fact!!!

Fitting

All work must be carried out in compliance with the applicable safety regulations (e.g. protective goggles).

Fitting time (1 unit = 5 minutes)

The fitting time is **4 unit**.

Required tool

- Torx wrench
- Allen key
- Torque wrench

Fitting Instructions No: S700371-F15 / Issue: 24.05.2023 / REV02

AC Schnitzer - automobile Technik - Neuenhofstraße 160 - D - 52078 Aachen - Tel. 0241/5688 -300

Components Supplied

Left side

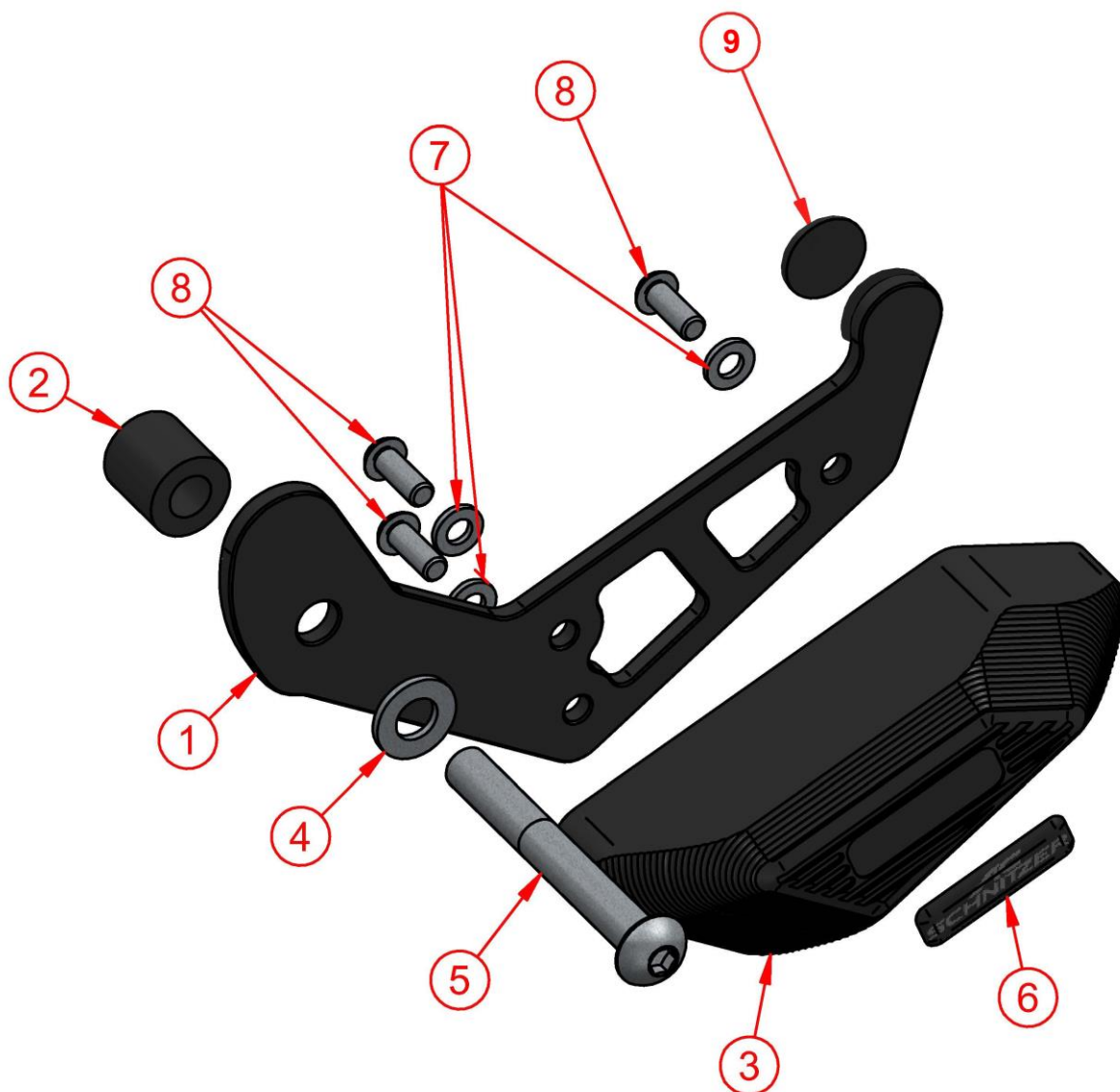

Pos.	Titel	Anzahl
1	Holder Crash Pad L BM1S	1
2	Sleeve Ø10,5 x Ø20 x 20 BM1S	1
3	Crash Pad BM1S	1
4	Washer DIN 125 - A 10,5	1
5	Hexagon head screw DIN 931 - M10 x 80	1
6	Logopin ACS 40x12	1
7	Washer DIN 125 - A 6,4 x 12	3
8	Pan head screw ISO 7380 - M6 x 16	3
9	Antivibration adhesive disk	1

Right side

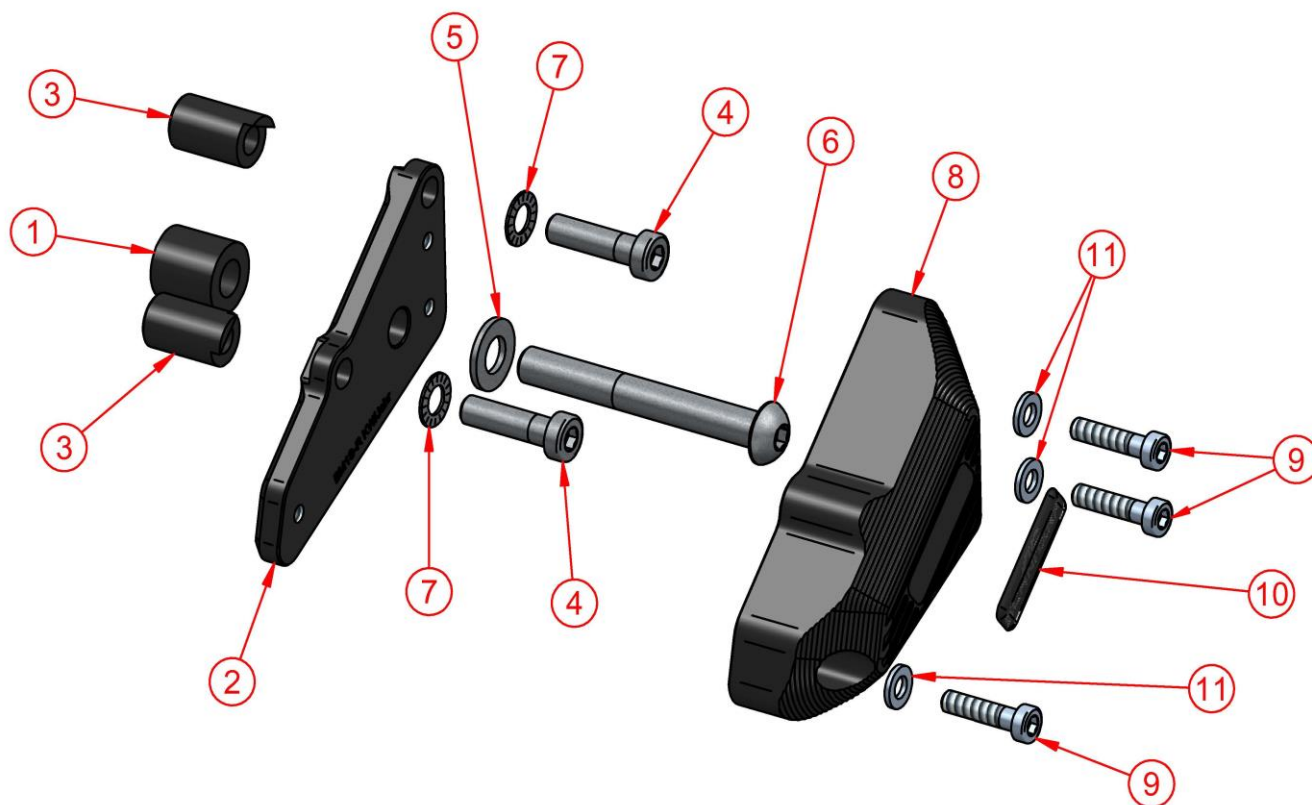

Pos.	Titel	Anzahl
1	Sleeve $\varnothing 10,5 \times \varnothing 20 \times 20$ BM1S	1
2	Holder Crash R BM1S	1
3	Anti-twist device BM1S	2
4	Cap screw M8 x 30	2
5	Washer 10.5	1
6	hexagon head screw M10 x 80	1
7	serrated lock washer 8.4	2
8	Crash Pad	1
9	Cap screw M6 x 25	3
10	Logopin ACS 40x12	1
11	Washer 6.4 x 12	3

Fitting instructions

AC Schnitzer – S1000RR –

Fitting

Right side:

Loosen and remove motor retaining screw (this will not be reused).



Insert the enclosed cap screws with washers through the base plate / holder, insert anti-rotation devices in the groove and fasten them so that they can still be moved.



Insert the enclosed spacer sleeve into the frame.



Place the base plate / holder between the frame with the with the supplied washer and screw.

Tighten the two anti-rotation locks -18 Nm.

Tighten the motor retaining screw -60 Nm.



Fitting instructions

**AC
SCHNITZER**

AC Schnitzer – S1000RR –

Fitting

Fasten the crash pad to the base plate / holder with the three enclosed cap screws and washers -8 Nm.



Clean the recess in the crash pad and insert the sticker and press it firmly into place.



Left side:

Insert the three pan-head screws with washers through the base plate / holder. Fasten the crash pad to the base plate / holder - 2.5 Nm.



Stick anti-vibration adhesive pad to base plate / holder as shown.



Fitting Instructions No: S700371-F15 / Issue: 24.05.2023 / REV02

AC Schnitzer - automobile Technik - Neuenhofstraße 160 - D - 52078 Aachen - Tel. 0241/5688 -300

Fitting instructions

**AC
SCHNITZER**

AC Schnitzer – S1000RR –

Note:

For better mounting, detach the side panel to create space in the mounting area.

Loosen and remove front motor retaining screw on left side (these will not be reused).

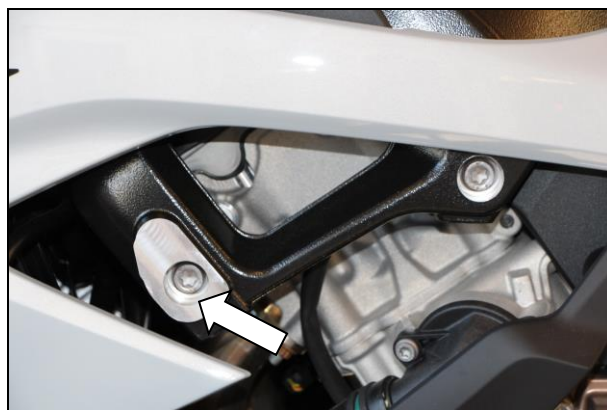

Insert the enclosed spacer sleeves into the frame.



Attach the base plate / holder to the vehicle frame.



Insert the base plate / holder at the rear motor mounting point in the bore and at the front mounting point with the washer and screw on the frame fixing screws -60 Nm.



Fitting Instructions No: S700371-F15 / Issue: 24.05.2023 / REV02

AC Schnitzer - automobile Technik - Neuenhofstraße 160 - D - 52078 Aachen - Tel. 0241/5688 -300

Fitting instructions

**AC
SCHNITZER**

AC Schnitzer – S1000RR –

Fit the screw cover supplied.



Clean the recess in the pad and insert the sticker and press firmly.



Errors and changes as well as technical further developments reserved !

Fitting Instructions No: S700371-F15 / Issue: 24.05.2023 / REV02

AC Schnitzer - automobile Technik - Neuenhofstraße 160 - D - 52078 Aachen - Tel. 0241/5688 -300