

AC SCHNITZER

- Mounting instructions -

Handlebar riser

- R nineT from 2014-



S700561-F25

General notes!



AC Schnitzer Handlebar riser

Important notes!

These installation instructions must be read in their entirety before starting the installation work.

completeness with regard to every step of the work. We reserve the right to make technical, editorial and content-related changes! AC Schnitzer accepts no liability for damage caused by improper installation!

Check the goods for completeness and integrity before starting work.

Later complaints cannot be considered.

These installation instructions are intended exclusively for use by authorised AC Schnitzer or BMW dealers.

BMW dealers. The target group for these installation instructions is in any case specialist personnel trained on BMW vehicles with the appropriate specialist knowledge and tools. Knowledge of material properties and standards is assumed! Work on steering systems should only be carried out by qualified personnel!

Before assembly:

Before fitting, the vehicle must be adequately secured to prevent it from rolling away or falling over. We recommend using the standard main stand or an original BMW assembly stand for this purpose!

Keep children and pets away from the work area! Danger of accident due to getting caught or electrical short circuit!

short circuit! Therefore, remove jewellery (chains, watches, rings, etc.) before starting work!

After installation:

After completion of the work, a test drive must be carried out if necessary! After the test drive has been completed, all screw connections must be checked for tightness and all moving parts must be checked for sufficient clearance.

Installation time (1 AW = 5 minutes)

The installation time is approx. 4 AW, which may vary depending on the condition and equipment of the vehicle.

(This value is only a recommendation and is not binding)!

Required tools:

- Standard Torx tool**
- Torque wrench**
- Screw glue / screw lock medium strength**

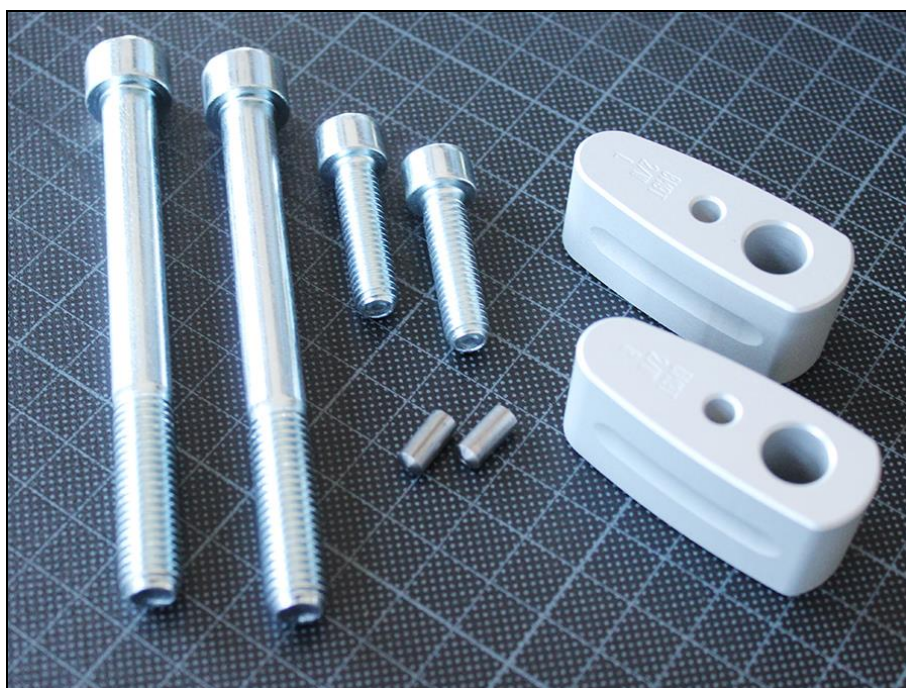
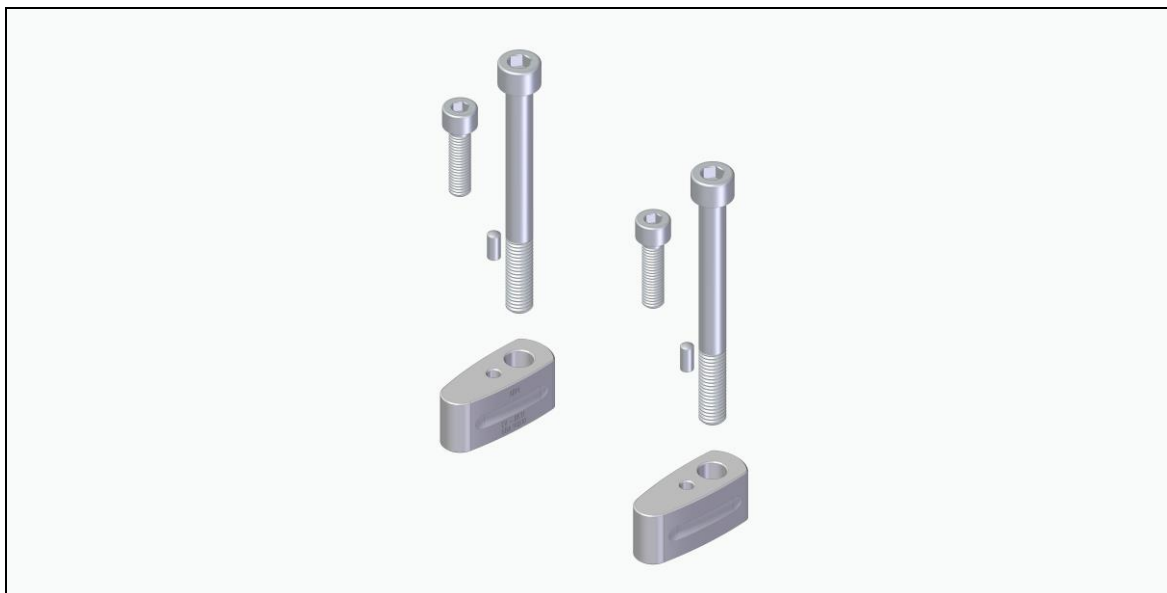

Handlebar riser kit (only available complete)	Anzahl
ACS BK11 clamp stool elevation, right	1
ACS BK11 clamping stool elevation, left	1
Cheese head screw DIN 912 M10x100	2
Dowel pin	2
Cheese head screw DIN 912 M8x30	2

Assembly:

Park the vehicle safely and secure it against rolling away.



Protect the working surface from damage, etc.



Loosen the four fastening screws of the handlebar counter-clockwise and remove it.

Hold the handlebar firmly and ensure that it cannot twist (risk of damage).



Remove the original upper clamp parts.

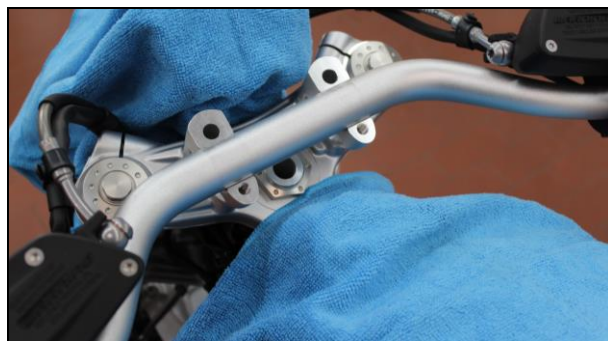

Remove the handlebars from the triple clamp and store them in a place protected against damage.



Assembly instructions



AC Schnitzer

Remove the standard lower clamp parts.

Clean the contact surfaces.



Insert the supplied AC Schnitzer handlebar risers into the standard cylindrical pins of the triple clamp.



Note the markings R (right) and L (left) on the handlebar risers.



Insert the two enclosed dowel pins into the handlebar riser.



Place the original clamp bases on the handlebar riser.



Apply "medium-strength" screw adhesive to the enclosed fastening screws.
"medium strength".



Insert the handlebar into the lower part of the clamp and align it.



Place the upper part of the clamp and screw in the prepared screws hand-tight.



Tighten the bolts according to the workshop manual.

Tightening torque front (M10): 38 Nm
Tightening torque rear (M8): 19 Nm



This component has an ABE!
It is mandatory that you carry this ABE with you on every journey.
The marking of the component is only on one of the two components!

It refers to the changed seat position and driving dynamics.
The free movement of all moving parts must be checked and, if necessary, re-established. Compatibility with other products has not been tested and cannot be guaranteed!

Errors excepted, subject to change and technical development!

