

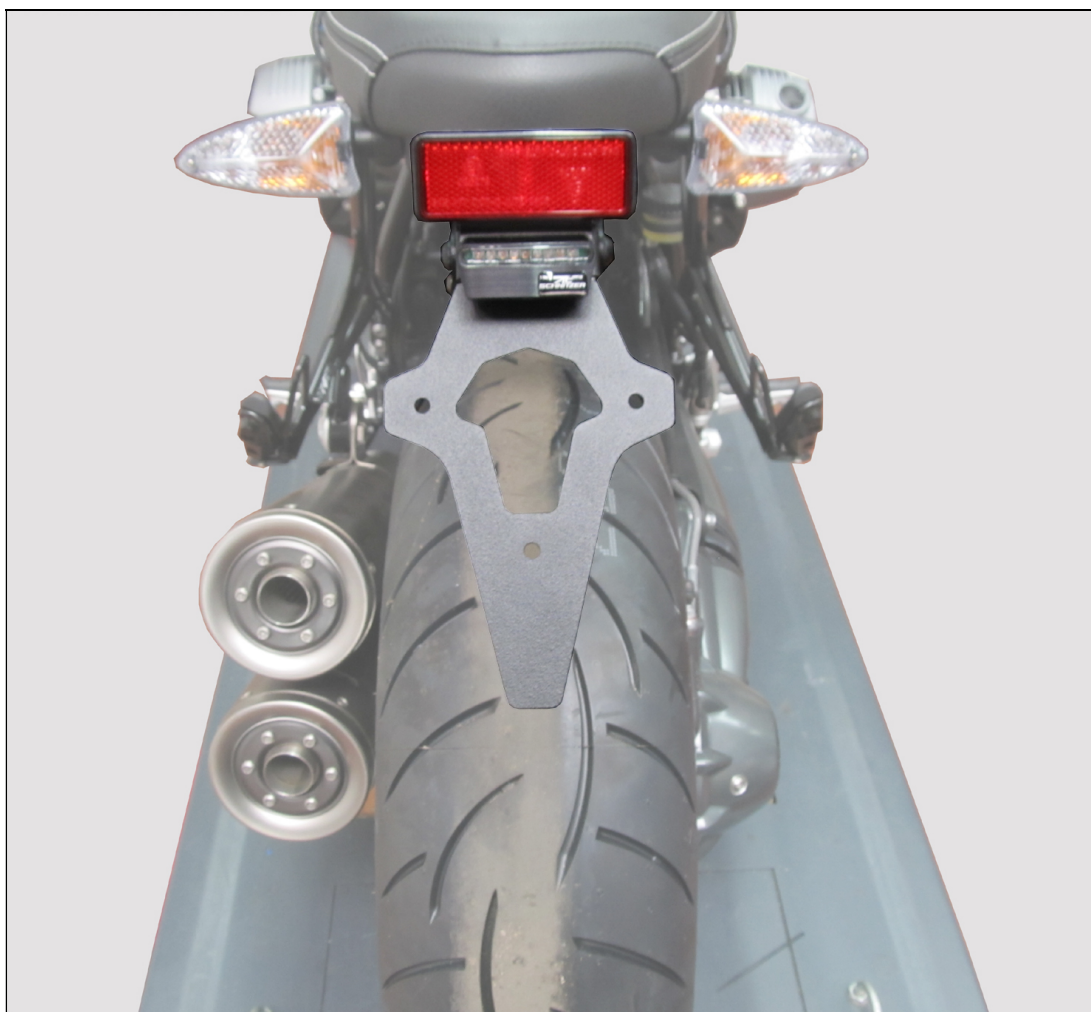

- Installation instructions -



Number plate holder, central version

BMW R nineT Scrambler & Urban GS from 2021

Part number: S700-69123-15 & 69123-A

General notes!



AC Schnitzer Number plate holder, central version

Important notes!

These installation instructions must be read in their entirety **before** starting the installation work and do not claim to be complete with regard to every step of the work. We reserve the right to make technical and editorial changes as well as changes in content! AC Schnitzer accepts no liability for damage caused by improper installation!

The compatibility with other direction indicators than the standard ones has not been tested.

Check goods for completeness and intactness **before** starting work. **For logistical reasons, you will receive more assembly parts for this conversion than are necessary. Components from 69123-A replace components from S 700-69123-15.**

Later complaints cannot be considered.

This product is intended exclusively for installation by authorised AC Schnitzer or BMW dealers. The target group for these installation instructions is always specialist personnel trained on BMW vehicles with the appropriate specialist knowledge and tools. Knowledge regarding material properties and standards is assumed! Work on electrical systems should only be carried out by competent persons!

This product is not suitable for self-assembly by the end user.

Before mounting:

For assembly, the vehicle must be adequately secured against rolling away or overturning.

We recommend using the standard main stand or an original BMW mounting stand! Keep children and pets away from the work area!

Danger of accident due to getting caught or electrical short circuit! Therefore, take off jewellery (chains, watches, rings, etc.) before starting work!

After mounting:

After completion of the work, a test drive must be carried out if necessary! After the test drive has been completed, all bolted connections must be checked for tightness and all moving parts must be checked for sufficient clearance.

Installation time (1 AW = 5 minutes)

The installation time is approx. 9 AW, which may vary depending on the condition and equipment of the vehicle. (This value is only a recommendation and is not binding!)

Required tools

- Standard Torx Tool Car
- Standard tool car
- Screw glue medium strength

Assembly instruction number: S700-69123-15 / REV:2 Stood: Montag, 13. Dezember 2021 RVo

AC Schnitzer Motorrad-Technik Neuenhofstraße 160 52078 Aachen ☎ 0241/5688 300 ✉ info@ac-schnitzer.de www.acschnitzer.shop

Table of contents



AC Schnitzer Number plate holder, central version

Chapter	Site
1. Delivered components	4
2. Mounting the AC Schnitzer number plate holder	5

Assembly instruction number: S700-69123-15 / REV:2 Stood: 13. Dezember 2021 RVo

AC Schnitzer Motorrad-Technik Neuenhofstraße 160 52078 Aachen ☎ 0241/5688 300 ✉ info@ac-schnitzer.de www.acschnitzer.shop

Delivered components



AC Schnitzer Number plate holder, central version

A

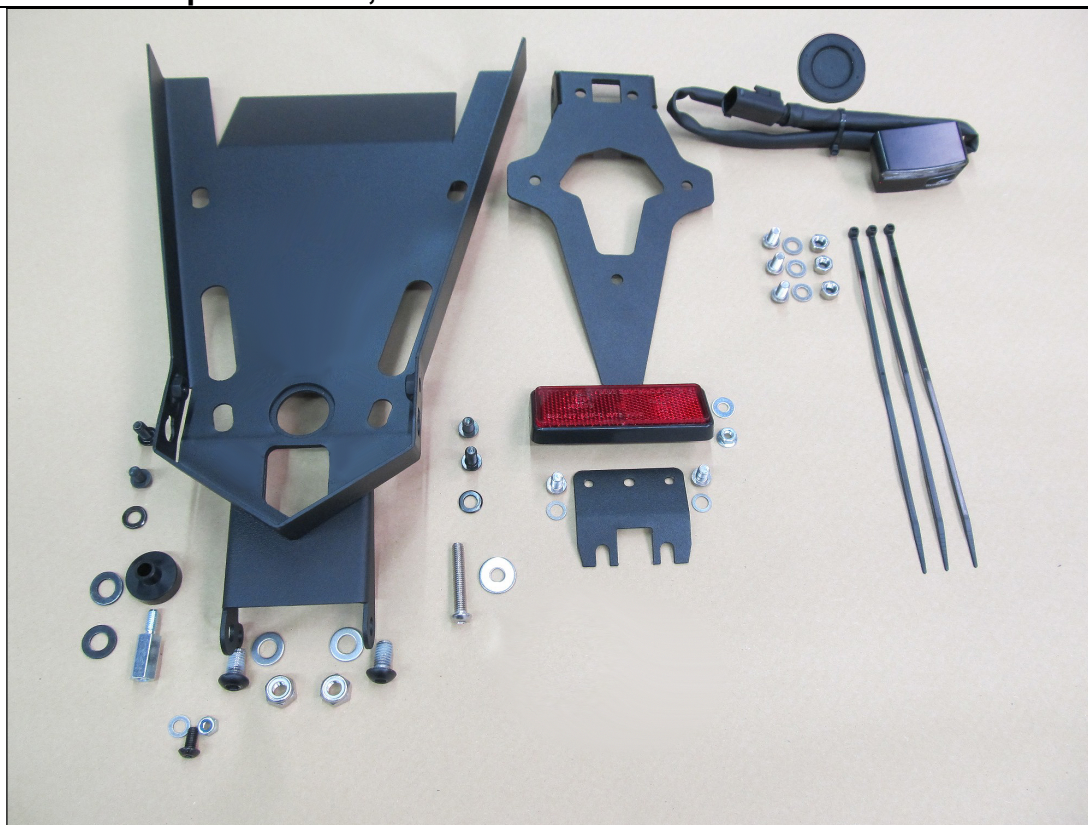

A AC Schnitzer Number plate holder, central version (S700-69123-15)



B Mounting kit Scrambler & Urban GS for AC Schnitzer S700-69123-15 (69123-A)

Assembly instruction number: S700-69123-15 / REV:2 Stood: 13. Dezember 2021 RVo

AC Schnitzer Motorrad-Technik Neuenhofstraße 160 52078 Aachen ☎ 0241/5688 300 ✉ info@ac-schnitzer.de www.acschnitzer.shop

Installation instructions



AC Schnitzer Number plate holder, central version

2. Mounting

- Before starting work, the vehicle must be parked safely and appropriately secured against falling over or rolling away. (Fig. 1)



- Dismantle the standard pillion seat (or aluminium hump). To do this, loosen the fastening screw and unscrew it completely. (Fig. 2)

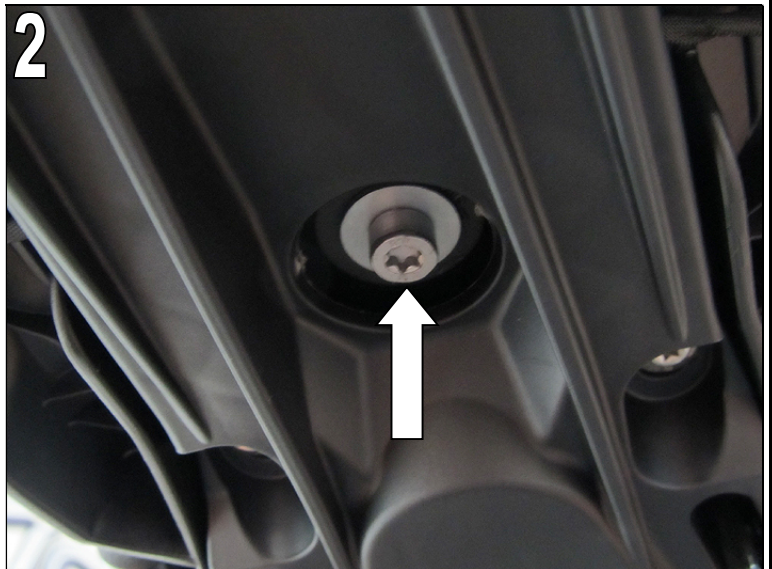

- Disconnect cable ties and exposed plug-in connections of the direction indicator lamps (Fig. 3)

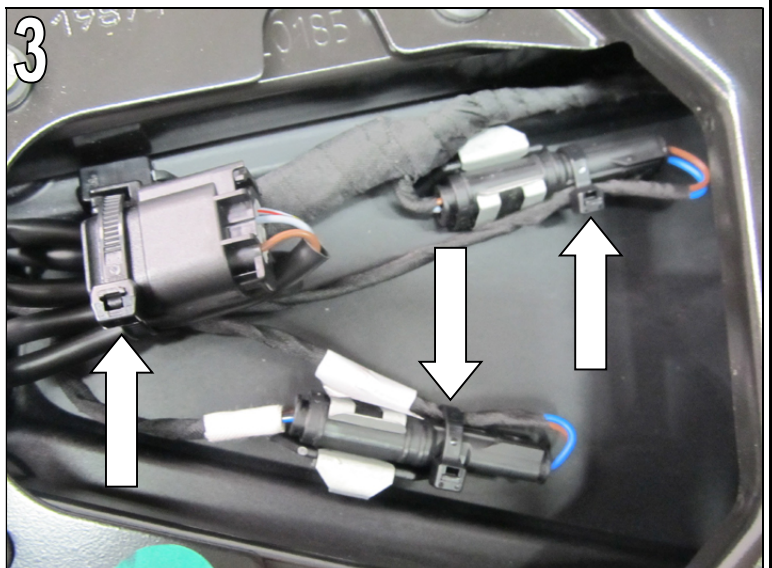

Assembly instruction number: S700-69123-15 / REV:2 Stood: 13. Dezember 2021 RVo

AC Schnitzer Motorrad-Technik Neuenhofstraße 160 52078 Aachen ☎ 0241/5688 300 ✉ info@ac-schnitzer.de www.acschnitzer.shop

Installation instructions



AC Schnitzer Number plate holder, central version

2. Mounting

- Loosen and unscrew both fastening screws of the inner cover (rear, in the area of the number plate). (Fig. 4)



- Loosen and unscrew all fastening screws of the standard licence plate holder. (Fig. 5)

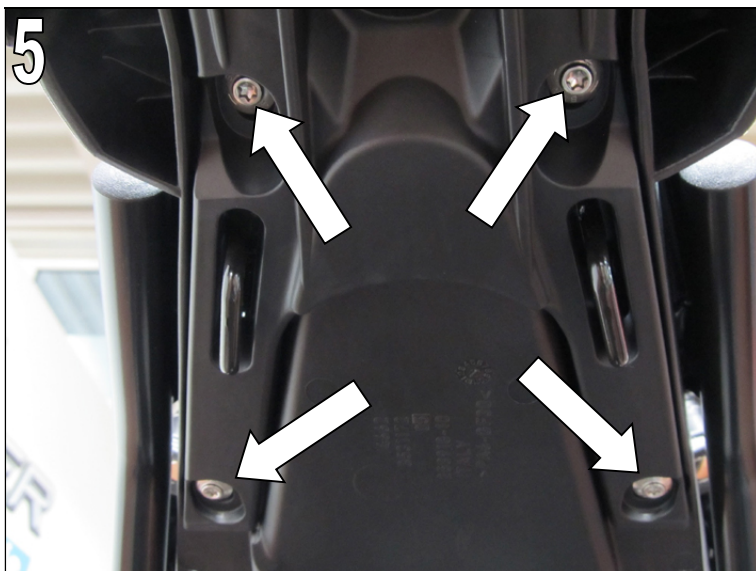

- Remove the inner cover from the number plate holder and disconnect the exposed plug connection to the standard tail light. Remove the complete standard licence plate holder from the vehicle. (Fig. 6)



Assembly instruction number: S700-69123-15 / REV:2 Stood: 13. Dezember 2021 RVo

AC Schnitzer Motorrad-Technik Neuenhofstraße 160 52078 Aachen ☎ 0241/5688 300 ✉ info@ac-schnitzer.de www.acschnitzer.shop

Installation instructions



AC Schnitzer Number plate holder, central version

2. Mounting

- Remove both direction indicators from the standard licence plate holder by unscrewing the 6 mm screw from the nut on both sides and turning the direction indicator until the locking lug can be removed freely. (Fig. 7)

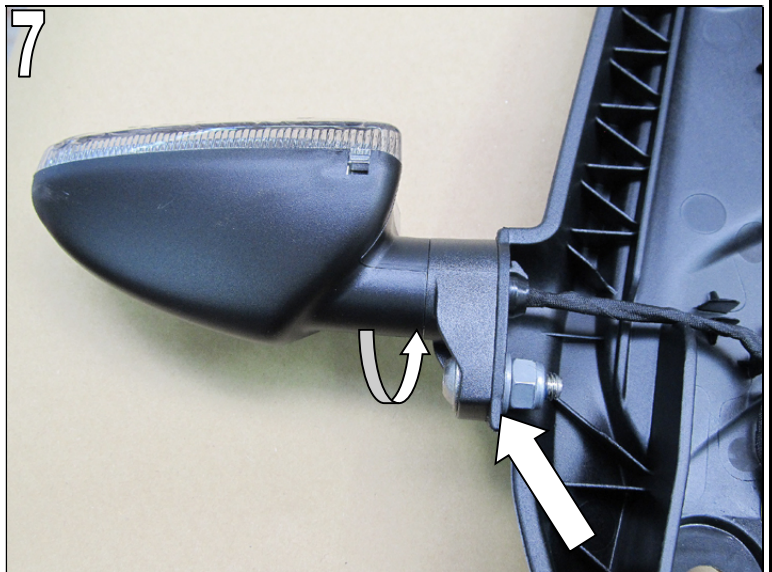

- Insert the connector socket and rubber seal of the supplied rear light wiring harness through the support part of the number plate.

- Loosely screw on the rear light through the licence plate holder using the screws and scroll washers supplied. (Fig. 8)

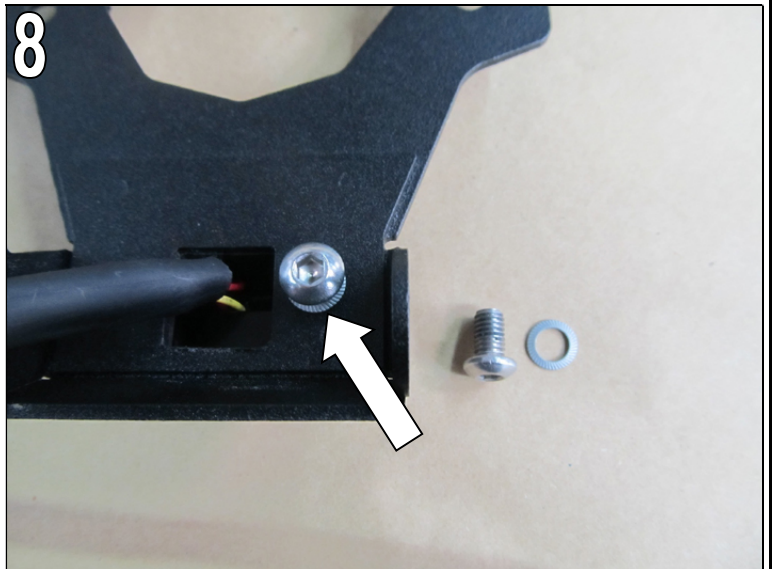

- Attach the supplied reflector to the retaining plate and fasten it with the washer and collar nut. (Fig. 9)

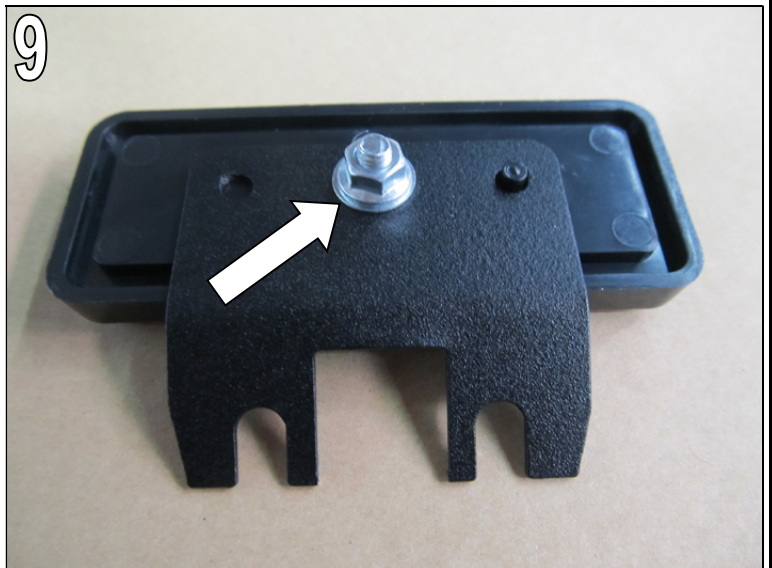

Assembly instruction number: S700-69123-15 / REV:2 Stood: 13. Dezember 2021 RVo

AC Schnitzer Motorrad-Technik Neuenhofstraße 160 52078 Aachen ☎ 0241/5688 300 ✉ info@ac-schnitzer.de www.acschnitzer.shop

Installation instructions



AC Schnitzer Number plate holder, central version

2. Mounting

- Insert and align the retaining plate of the reflector between the rear light and the support plate as shown in the illustration. Tighten the fastening screws of the rear light. (Fig. 10)

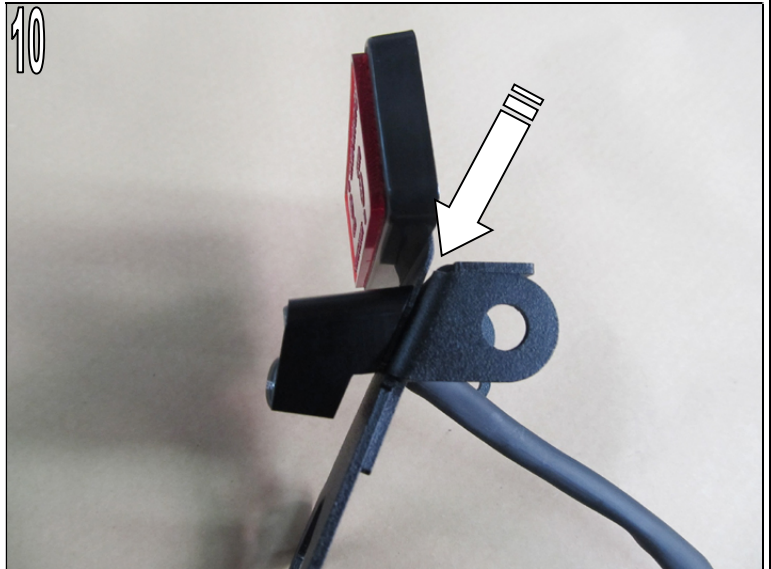

- Insert the prepared licence plate holder between the mounting brackets of the inner wing as shown in the illustration and attach the supplied 8.0 mm Allen screws (black), washer and self-locking nut on both sides. (Fig. 11)

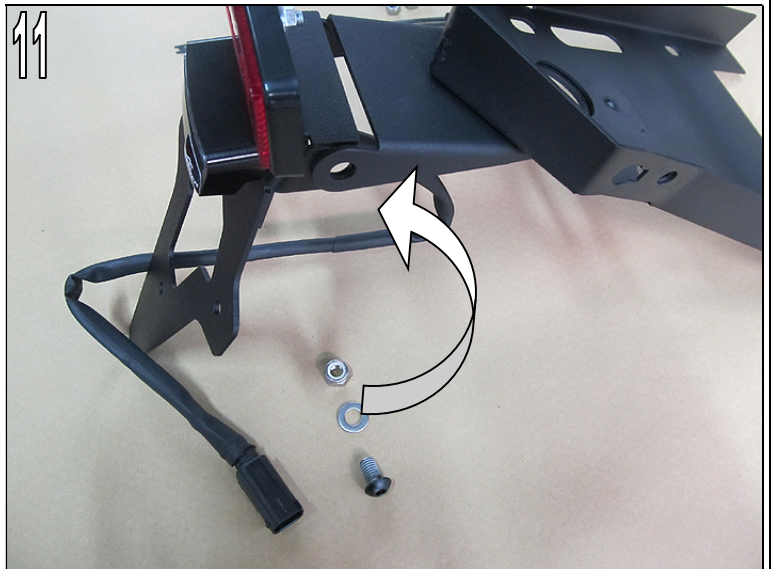

- Position the bore holes of the anti-twist device so that they are congruent, insert the 5mm Allen head screw from the outside to the inside and fit a washer and self-locking nut.
- Finally, tighten all 3 screws. (Fig. 12)



Assembly instruction number: S700-69123-15 / REV:2 Stood: 13. Dezember 2021 RVo

AC Schnitzer Motorrad-Technik Neuenhofstraße 160 52078 Aachen ☎ 0241/5688 300 ✉ info@ac-schnitzer.de www.acschnitzer.shop

Installation instructions



AC Schnitzer Number plate holder, central version

2. Mounting

- Guide the wiring harness of the rear light through the hole in the inner mudguard and fix the rubber grommet in the hole.
- Insert the cables of the direction indicators (FRA) through the holes provided on the side of the inner cover.
- Place the FRA on the inner support so that the locking lug can be inserted through the inner support. Then turn FRA to the appropriate position (Fig. 13).



- Fix the direction indicator (FRA) with the supplied Allen screws. Standard FRAs with bulbs (thick base) are fixed with M6 x 14mm screws, standard LED FRAs are fixed with M6 x 10mm screws. In any case, it must be ensured that the ventilation opening is on the bottom during installation.
- The fixing screws used must be coated with screw adhesive before installation.
- This installation guide only describes the installation of the standard FRA, other components were not tested (Fig. 14)
- Secure the foot of the FRA with the clip supplied.

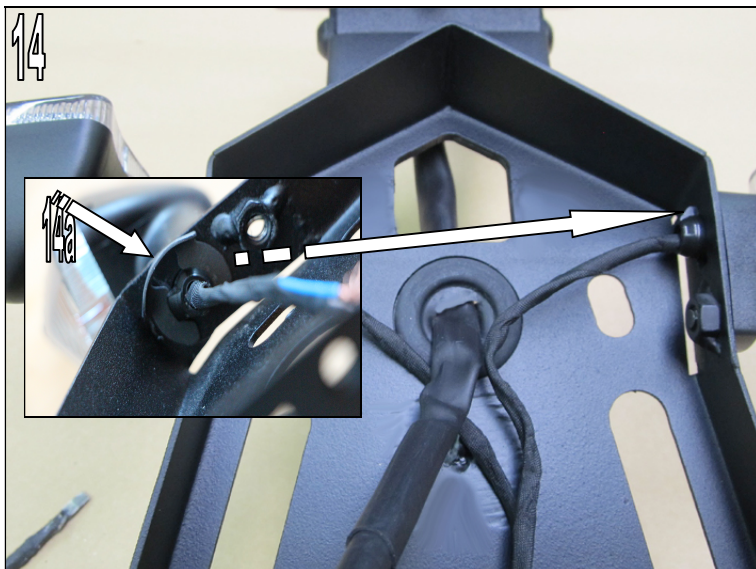

(Only with material thickness 1.5mm Fig. 14a)

- The angle in the area of the inner mudguard must be checked on the vehicle and bent if necessary.

To do this, heat the inner mudguard with a hot air blower and correct the angle of the metal tongue without damaging the coating. (Fig. 15)

(Note: On the BMW SCRAMBLER, the angle is approx. 30°)

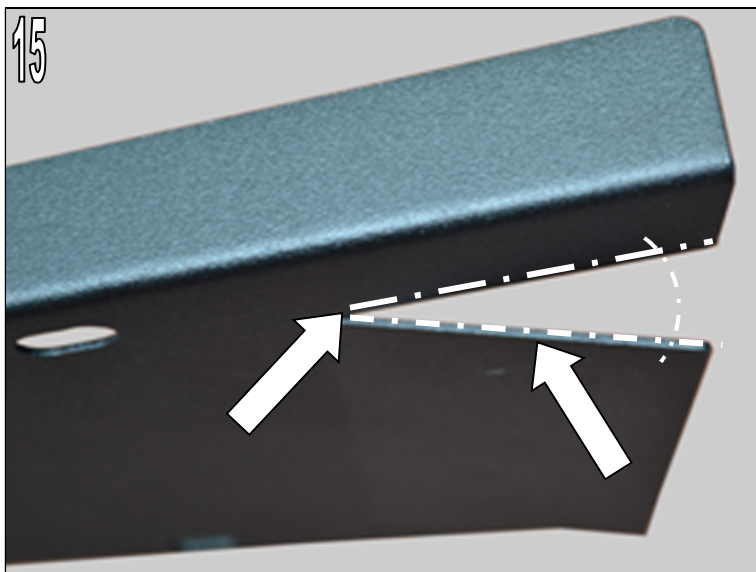

Assembly instruction number: S700-69123-15 / REV:2 Stood: 13. Dezember 2021 RVo

AC Schnitzer Motorrad-Technik Neuenhofstraße 160 52078 Aachen ☎ 0241/5688 300 ✉ info@ac-schnitzer.de www.acschnitzer.shop

Installation instructions



AC Schnitzer Number plate holder, central version

2. Mounting

- Fix the 4 spacers on the inside (arrows Fig. 16) on the inside, e.g. with grease or double-sided adhesive tape. On the picture the distances are white for better visibility. In your scope of delivery made of black anodised aluminium.

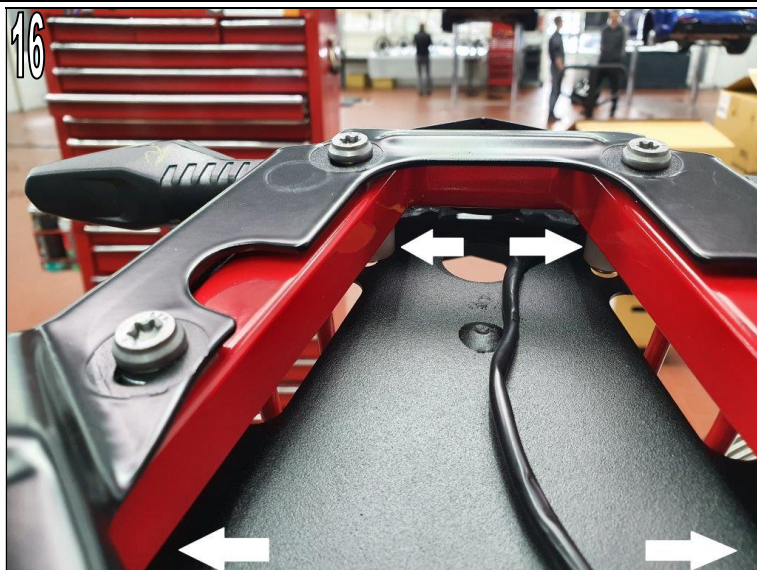

- Position the inner mudguard on the vehicle from below as shown in the illustration and fasten with M5 x 30 screws with collar head (black). **Make sure that the inner mudguard is pulled backwards (against the direction of travel) as far as possible within the slotted holes.** (Fig. 16 & 17)

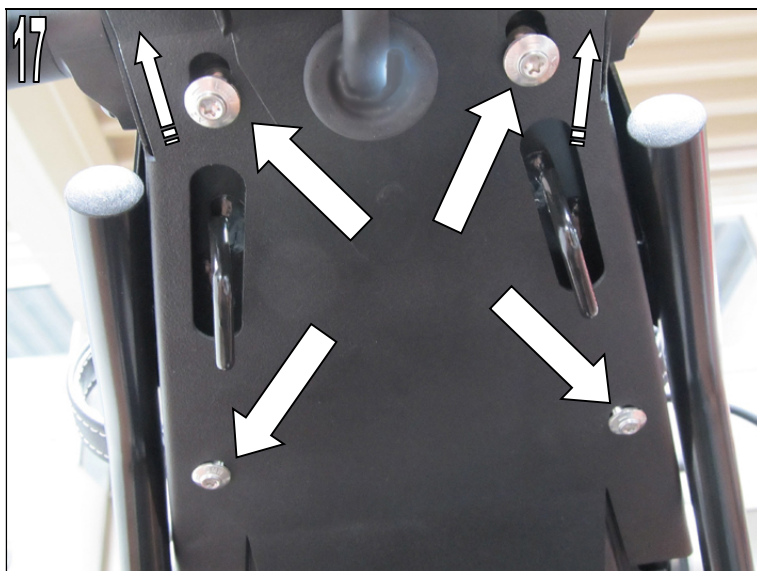

- Check the contact contour of the sheet metal tongue on the vehicle after installation, bend if necessary. (Fig. 15)

- Connect the cable plugs of the FRA, paying attention to the standard markings (white stickers). Plugging together the connector of the rear light. Lay the cables with the cable ties supplied. Then install the standard pillion seat (or similar). Make sure that the clamping bracket does not pinch or damage any cables. (Fig. 18)



Assembly instruction number: S700-69123-15 / REV:2 Stood: 13. Dezember 2021 RVo

AC Schnitzer Motorrad-Technik Neuenhofstraße 160 52078 Aachen ☎ 0241/5688 300 ✉ info@ac-schnitzer.de www.acschnitzer.shop

Installation instructions



AC Schnitzer Number plate holder, central version

2. Mounting

- On BMW SCRAMBLERs, the threaded extension included in the scope of delivery must be screwed into the standard seat and the seat fastened with the M6 x 30 Torx screw. (Fig. 19)

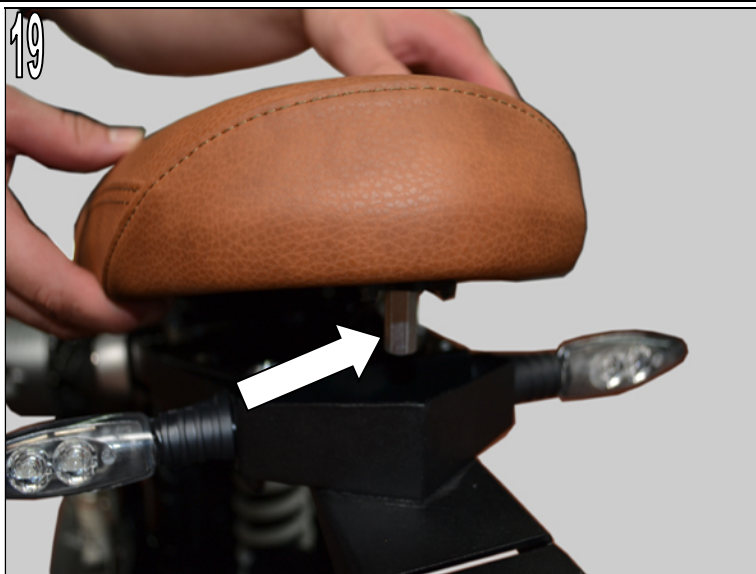

- When using the BMW aluminium hump, remove the bushing in the rubber of the fastening screw and replace it with the supplied bushing.

In any case, make sure that the FRAs are not bent when tightening the fastening screw.
(Fig. 20)



- Fix the licence plate to the licence plate holder with the supplied Allen screws, washers and self-locking nuts.
- Check lighting before delivery! (Fig. 21)

- The licence plate holder fitted in accordance with these installation instructions is not subject to registration.
- Changes in the angle ($< 30^\circ$ to the road surface) of the registration plate are not permissible!



Assembly instruction number: S700-69123-15 / REV:2 Stood: 13. Dezember 2021 RVo

AC Schnitzer Motorrad-Technik Neuenhofstraße 160 52078 Aachen ☎ 0241/5688 300 ✉ info@ac-schnitzer.de www.acschnitzer.shop

More AC Schnitzer products for your BMW R nineT / SCRAMBLER

Connecting pipe in high-up version, suitable
e.g. for AC Schnitzer STEALTH silencer,
for a clear view of the rear wheel



Fuel filler cap "Heritage"
Retro fuel filler cap in high-end finish,
with "turn-click" closure.



Fluid reservoir covers for clutch and brake side.
Anodised and then remilled.
Perfect aluminium look in typical
AC Schnitzer design.



AC S2 clutch and brake lever, 6-position adjustable
while riding. Including 2 sets of milled interchange-
able plastic end pieces in long and short version.
With ABE! No registration necessary.

