



- Assembly instructions -

Crash pads

– F 900R/XR from model 2020–



part-no.: S700400-F15

General information!



AC Schnitzer

Important notes!

It is essential to read these installation instructions before starting the installation work. AC Schnitzer accepts no liability for damage caused by improper installation!

These installation instructions are intended exclusively for use by authorised AC Schnitzer or BMW dealers. The target group for these installation instructions is in any case specialist personnel trained on BMW vehicles with the appropriate specialist knowledge and tools. Knowledge of material properties and standards is assumed!

The crash pads offered by AC Schnitzer provide protection for the frame and attachments in the event of "overturns" or so-called "slips". Unfortunately, even these components are no guarantee of accidents without consequential damage. It is quite possible that the crash pads will catch on protruding parts such as curbs, manhole covers, kerbs, etc. in the event of a "skid" and give way under the force exerted.

Any resulting consequential damage is the sole responsibility of the person who caused the fall and cannot be claimed from AC Schnitzer. -Please inform your customers of this fact!

Assembly

All work must be carried out in accordance with the applicable safety regulations (e.g. protective goggles).

Painting

- not applicable!

Installation time (1 AW = 5 minutes)

The installation time is approx. 4 AW, which may vary depending on the condition and equipment of the vehicle.

Painting time (1 AW = 5 minutes)

- not applicable.

Required tool

- Torx key
- Allen key
- Torque spanner

Left side

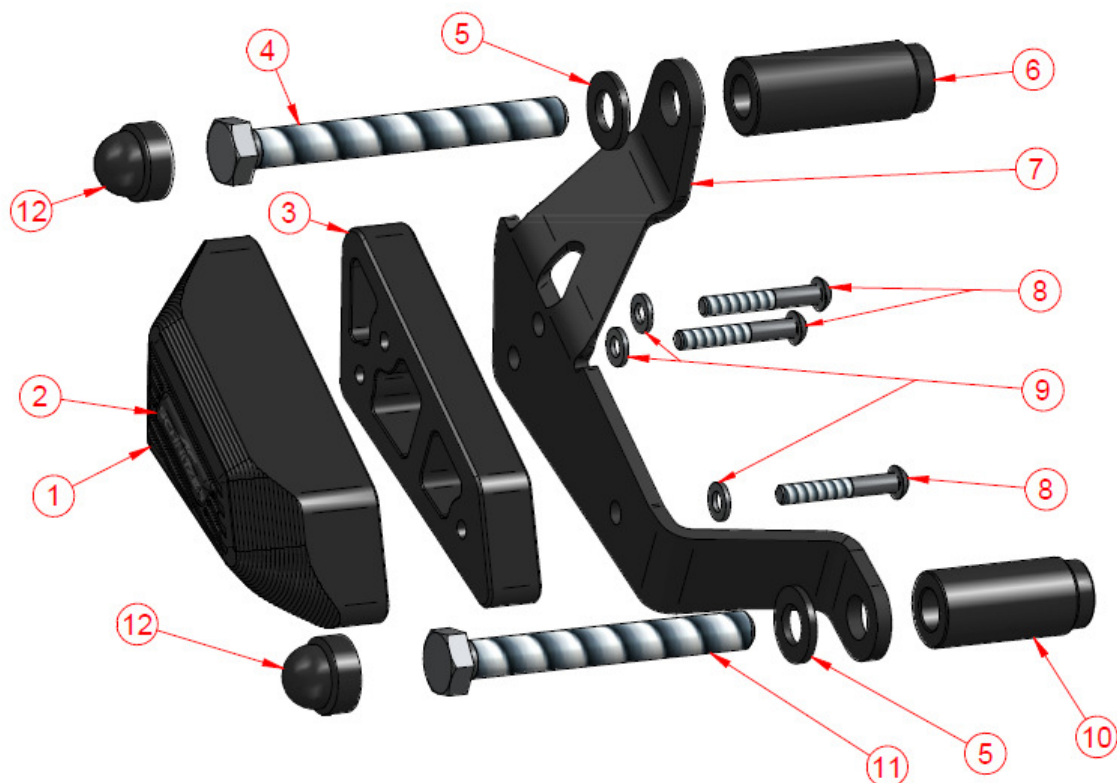

Pos.	Titel	Anzahl
1	Sturzpad L BM1S/BMF9T	1
2	Logopin ACS 40x12	1
3	Sturzpad Unterlage BMF9T	1
4	Sechskantschraube DIN 933 M12x110	1
5	Scheibe DIN 125 - A 13	2
6	Distanzrolle Ø24/21xØ13x62	1
7	Bügel Sturzpad L BMF9T	1
8	Linsenschraube ISO 7380 - M6 x 40	3
9	Scheibe DIN 125 - A 6,4	3
10	Distanzrolle Ø24/21xØ13x52	1
11	Sechskantschraube DIN 933 M12x100	1
12	Abdeckkappe für SW 19 Außensechskant	2

Right side

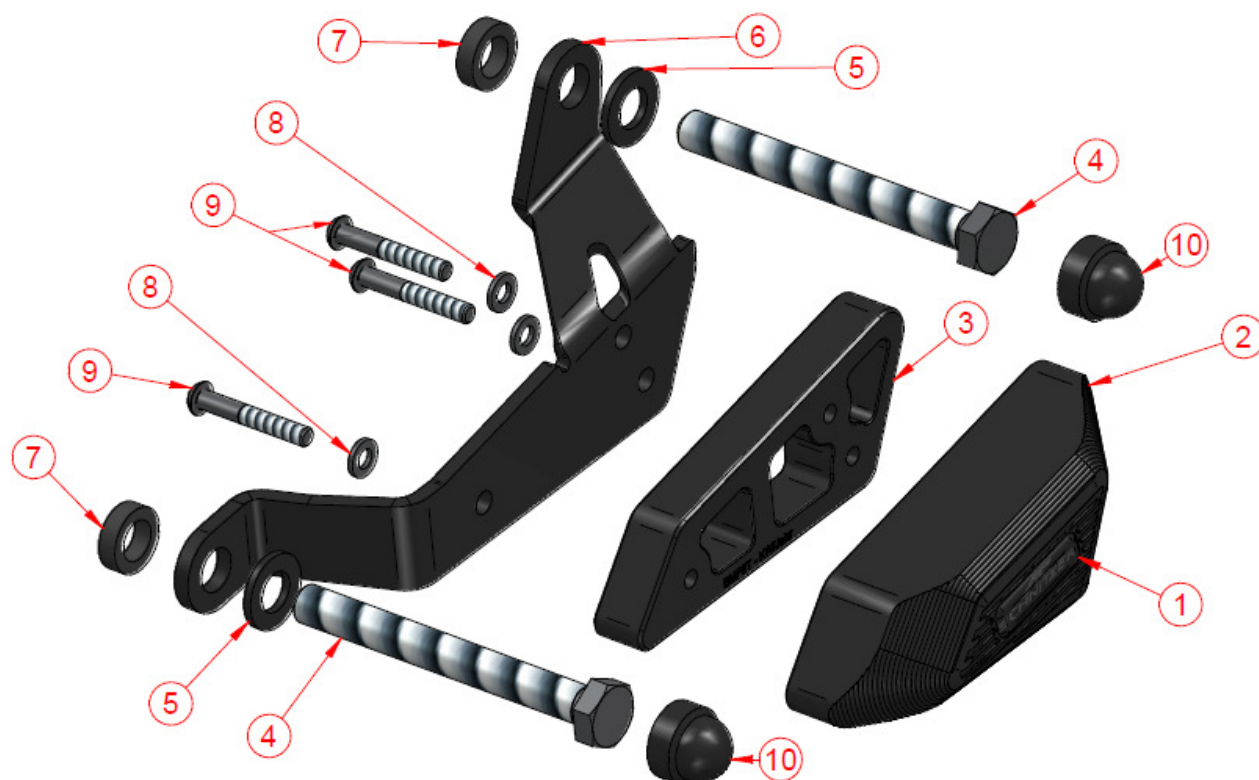

Pos.	Titel	Anzahl
1	Logopin ACS 40x12	1
2	Sturzpad R BMF9T	1
3	Sturzpad Unterlage BMF9T	1
4	Sechskantschraube DIN 933 M12x110	2
5	Scheibe DIN 125 - A 13	2
6	Bügel Sturzpad R BMF9T	1
7	Distanzrolle Ø21xØ13x6	2
8	Scheibe DIN 125 - A 6,4	3
9	Linsenschrauben ISO 7380 - M6 x 40	3
10	Abdeckkappe für SW 19 Außensechskant	2

Assembly instructions

AC
SCHNITZER

AC Schnitzer

Assembly

Right side:

Loosen and remove both motor retaining screws (these will not be reused).

On the F 900 XR model, remove the side panel beforehand..

Mount the pad and the underlay to the base plate with the enclosed screws and washers..

Torque 4.5 Nm.

Insert the enclosed short spacer sleeves into the frame.

Lightly grease the screw thread.

Secure the base plate with the enclosed washers and screws (M12x110).

Torque 85 Nm

Clean the adhesive surface in the pad and apply the sticker.

Press the plastic covers onto the screw heads.

On model F 900 XR, refit the side panel.



Assembly instructions

AC[®]
SCHNITZER

AC Schnitzer

Left side:

Loosen and remove both motor retaining screws (these will not be reused).

On the F 900 XR model, remove the side panel beforehand.

Mount the pad and the underlay to the base plate with the enclosed screws and washers.

Torque 4.5 Nm.

Insert the enclosed spacer sleeves (with the smaller diameter facing inwards) into the frame.

Attention: The longer spacer sleeve (62 mm) is used at the front.

Lightly grease the screw thread.

Fasten the base plate with the enclosed washer and screw (M12x110 at the front, M12x100 at the rear)..

Torque 85 Nm

Clean the adhesive surface in the pad and apply the sticker.

Press the plastic covers onto the screw heads.

On model F 900 XR, refit the side panel.

Irrtum und Änderung vorbehalten!



Assembly instructions no.: S700400-F15 / date: 12.11.2020

AC Schnitzer - Motorradtechnik - Neuenhofstraße 160 - D - 52078 Aachen - phone. 0241/5688 -300 Fax -135