

AC[®] SCHNITZER

-Assembly instruction-

Steering conversion

-BMW F 800 R-



Part-No.: S50801540406

AC Schnitzer steering conversion BMW F 800 R

Important information!

These assembly instructions must be read completely before starting the installation work and do not claim to be complete with regard to every step of the installation process. Subject to technical and editorial changes, as well as changes in content! AC Schnitzer accepts no liability for damage caused by improper installation!

Check the goods for completeness and integrity before starting work.

Later complaints cannot be considered.

These assembly instructions are intended for use only by authorised AC Schnitzer or BMW dealers. The target group of these assembly instructions is in all cases BMW vehicles trained specialist personnel with the appropriate expertise and tools. Knowledge of material properties and standards is required! It is recommended that critical areas be protected with heat protection film or similar. to protect against excessive heat ingress. (e. g. BMW Part No.46 54 2 316 316 611)

Before assembly:

The vehicle must be adequately secured against rolling away or falling over for installation.

For this purpose, it is recommended to use the standard main stand or an original

BMW mounting stand! Keep children and pets away from the work area!

Risk of accident due to catching or electrical short circuit! Therefore, you should deposit jewellery (chains, watches, rings, etc.) before starting the work!

After assembly:

After completion of the work, a test drive may have to be carried out unless the function and the free movement of the component can be checked otherwise! After the test run has been completed, all bolted connections must be checked for firm seating and all moving parts checked for sufficient clearance.

Installation time (1 AW = 5 minutes)

The installation time is approx. 18 AW, which can vary depending on the condition and equipment of the vehicle.

(This value is only a recommendation and is not binding!)

Required tool

- Standard Torx tool KFZ
- Torque wrench
- Brake bleeding device
- Drill / drill 4,0mm
- Screw adhesive medium hard

AC Schnitzer steering conversion BMW F 800 R

Chapter	Seite
1. delivered components	4
2. Assembly of the AC Schnitzer steering conversion	5

Delivered components



AC Schnitzer steering conversion BMW F 800 R

A



A C Schnitzer

Assembly instruction No.: S4782 085209 / issue: 05.10.2017 RVo

AC Schnitzer - Neuenhofstraße 160 - D - 52078 Aachen - Phone. 0241/5688 -300 fax -135 / www.ac-schnitzer.de

Assembly instruction



AC Schnitzer steering conversion BMW F 800 R

2. Assembly

- Park the vehicle safely and secure it against falling over or rolling away. (Fig. 1)



- On both sides: Loosen the standard handlebar weights and remove them from the handlebar. (Fig. 2)



- On both sides: Push up the rubber grommet of the mirror mounting. Loosen and unscrew the lower fixing nut, remove the mirror from the steering rod. (Fig. 3)



Assembly instruction No.: S4782 085209 / issue: 05.10.2017 RV0

AC Schnitzer - Neuenhofstraße 160 - D - 52078 Aachen - Phone. 0241/5688 -300 fax -135 / www.ac-schnitzer.de

Assembly instruction



AC Schnitzer steering conversion BMW F 800 R

2. Assembly

- On the left-hand side (direction of travel): fold the handle end outwards and loosen and pull out the exposed Torx fixing screw..
- Do not remove the handle unit yet! (Fig. 4)



- On the left side (direction of travel): Loosen and remove the fixing screws of the manual fitting, remove the manual fitting from the handlebar. (Fig. 5)



- On the right-hand side (direction of travel): Use a Torx screwdriver (TX8) to loosen the fixing screw and remove the cover cap by drilling the hole in the cover cap of the electrical unit..
- Unscrew the exposed second fixing screw of the electrical unit, carefully disconnect the connectors and remove the electrical unit. (Fig. 6)

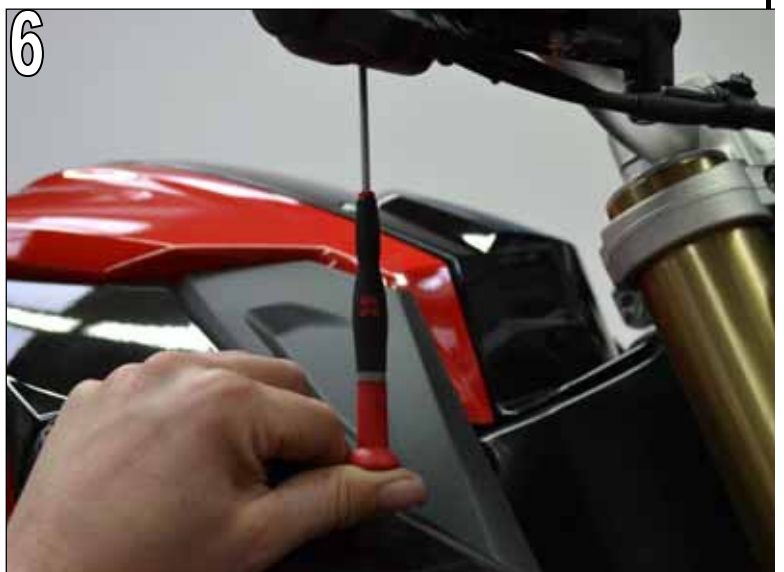

Assembly instruction



AC Schnitzer steering conversion BMW F 800 R

2. Assembly

- Loosen and remove the fixing screw of the gas handle..
- In vehicles with "E-Gas" disconnect the plug connection to the throttle twist grip.
- Remove the throttle grip from the handlebar.
- Unscrew the fixing screws of the manual valve and remove the manual valve from the handlebar. (Fig. 7)



- Unscrew the torx screws of the handlebar clamp and remove the handlebar from the vehicle, removing the left-hand electrical unit from the handlebar. (Fig. 8)



- Push the AC Schnitzer superbike handlebars into the left electropneumatic unit and insert the tubular handlebars centrally into the lower clamping blocks. (Fig. 9)



Assembly instruction



AC Schnitzer steering conversion BMW F 800 R

2. Assembly

- Put on the upper part of the clamping block, align the handlebars and secure the end of the clamping blocks by screwing the front screws (in the direction of travel) onto the block, then tighten the rear screws with 18Nm. (Fig. 10)



- For vehicles with "E-Gas":

Another mounting hole with max. 4mm diameter and 7mm spacing

Drill the hole centre - hole centre.



- Push on and fix the standard gas twist grip and tighten the end of the gas twist grip, reconnect the plug connection.

- Apply plugs to the electrical unit, insert and secure it (Fig. 12)



Assembly instruction



AC Schnitzer steering conversion BMW F 800 R

2. Assembly

- On the right-hand side (direction of travel):
- Loosen and unscrew the fixing screw of the fairing.
- Loosen and remove the water cooler fixing screw (concealed). (Fig. 13)



- On the left-hand side (direction of travel):
- Loosen and remove the fixing screw of the fairing and remove it.
- Push the water cooler to the left (direction of travel) out of the support and place it in front. (Fig. 14)



- Dismantle the standard one-way brake line and disconnect it from the vehicle with a manual valve..
- Equip the supplied AC Schnitzer one-way brake line with new sealing rings and lay it in the same way as the standard brake line. (Fig. 15)
- Slide the water cooler back into the mounting holes, position it and secure it with the standard screws.

TIP: The cable harness is attached to the frame in the area of the radiator attachment with a cable tie on the left side of the vehicle..

- Disconnect this cable tie, carefully push the cable harness to the side, then install the water cooler. Finally, reattach the cable harness with a new ties.

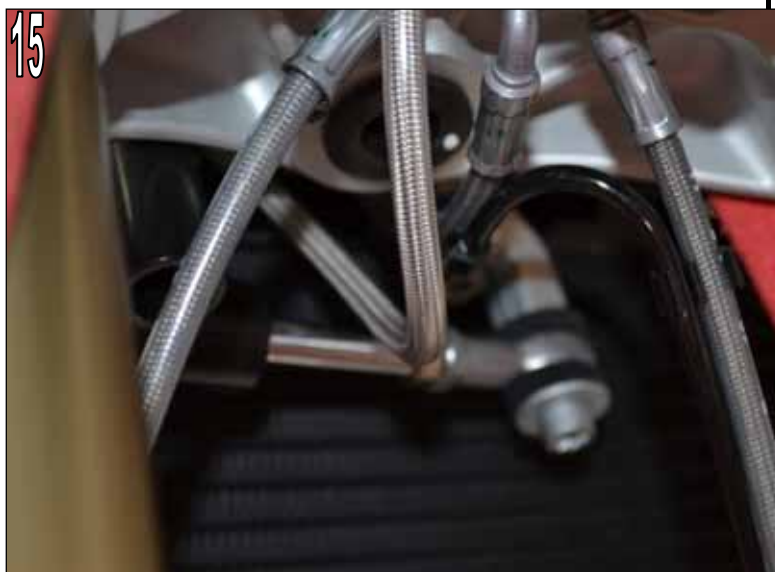

Assembly instruction No.: S4782 085209 / issue: 05.10.2017 RVo

AC Schnitzer - Neuenhofstraße 160 - D - 52078 Aachen - Phone. 0241/5688 -300 fax -135 / www.ac-schnitzer.de

Assembly instruction



AC Schnitzer steering conversion BMW F 800 R

2. Montage

- Release and remove the brake line from the manual valve as standard.
- Mount AC Schnitzer brake line.
- Mount the hand valve to the AC Schnitzer superbike handlebars and fasten it to the end of the handlebars..
- **CAUTION:** Neutralize the escaping brake fluid immediately!



- Equip the supplied handlebar weights with the large aluminium turned parts, coat the screws with screw lock and screw on the spreader. (Fig. 17)



- Slide the prepared handlebar end weights into the handlebar end and tighten the Allen screw.
 - Make sure that the throttle grip is not blocked by the handlebar weight!
- (Fig. 18)



Assembly instruction No.: S4782 085209 / issue: 05.10.2017 RVo

AC Schnitzer - Neuenhofstraße 160 - D - 52078 Aachen - Phone. 0241/5688 -300 fax -135 / www.ac-schnitzer.de

Assembly instruction



AC Schnitzer steering conversion BMW F 800 R

2. Assembly

- Push in the supplied end cap of the handlebar weight with rotary movement.
- Moisten the rubber ring with a little water beforehand.
- **WARNING:** Do not use silicone, oil or similar materials, as the handlebar weight will become loose. (Fig. 19)



- Mount the supplied mirror extensions as shown in the illustration. Apply screw glue to the fastening screws before screwing in.
- Make sure that no switches are covered during installation.
- Screw the mirror onto the mirror extensions and fasten it in place. Apply screw glue to the threaded end of the standard rear view mirror before screwing in. (Fig. 20)



- Final Work:

- Attach the cables of the electrical units to the handlebar using cable ties..
- Fill and bleed brake system according to BMW regulations.
- Check the function of the electrical unit.
- Test drive and test the brake system.
- Check all screws for tightness.
- The component is subject to registration, i. e.:
After conversion, the vehicle must be presented to an officially recognised expert and the vehicle documents must be corrected!