

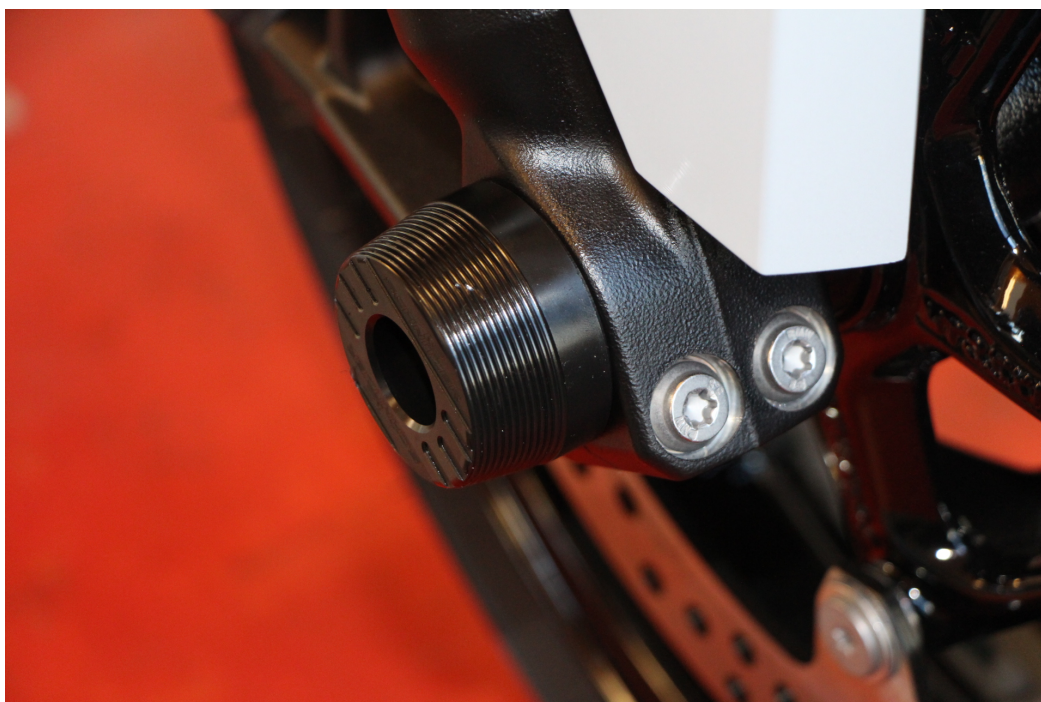

- Installation instructions -

Front axle pads

– F 900 R/XR –



Part number: S700398-F15

General notes!



AC Schnitzer – F900R/XR –

Important notes!

It is essential to read these installation instructions before starting installation work. AC Schnitzer accepts no liability for damage caused by improper installation!

These installation instructions are intended exclusively for use by authorised AC Schnitzer or BMW dealers. The target group for these installation instructions is always specialist personnel trained on BMW vehicles with the appropriate specialist knowledge and tools. Knowledge regarding material properties and standards is assumed!

The crash pads offered by AC Schnitzer provide protection for the frame and the add-on parts in the event of "overturns" or so-called "slips". Unfortunately, even these components are no guarantee for accidents without consequential damage. So it is quite possible that the crash pads hook onto protruding parts such as curbs, manhole covers, kerbs, etc. during "slides" and give way to the force acting on them.

Any resulting consequential damage is the sole responsibility of the person who caused the fall and cannot be claimed from AC Schnitzer. Please inform your customers of this fact!

Mounting

All work must be carried out in accordance with the applicable safety regulations (e.g. protective goggles).

Paint

n/a

Installation time (1 AW = 5 minutes)

The installation time is approx. **1 AW**, which may vary depending on the condition and equipment of the vehicle.

Paint (1 AW = 5 minutes)

n/a

Required tool

- 13 mm socket spanner

Assembly instruction number: S700398-F15 / Stood: 09.11.2020

AC Schnitzer - Motorradtechnik - Neuenhofstraße 160 - D - 52078 Aachen - Tel. 0241/5688 -300 Fax -135

Delivered components

AC Schnitzer – F900R/XR –

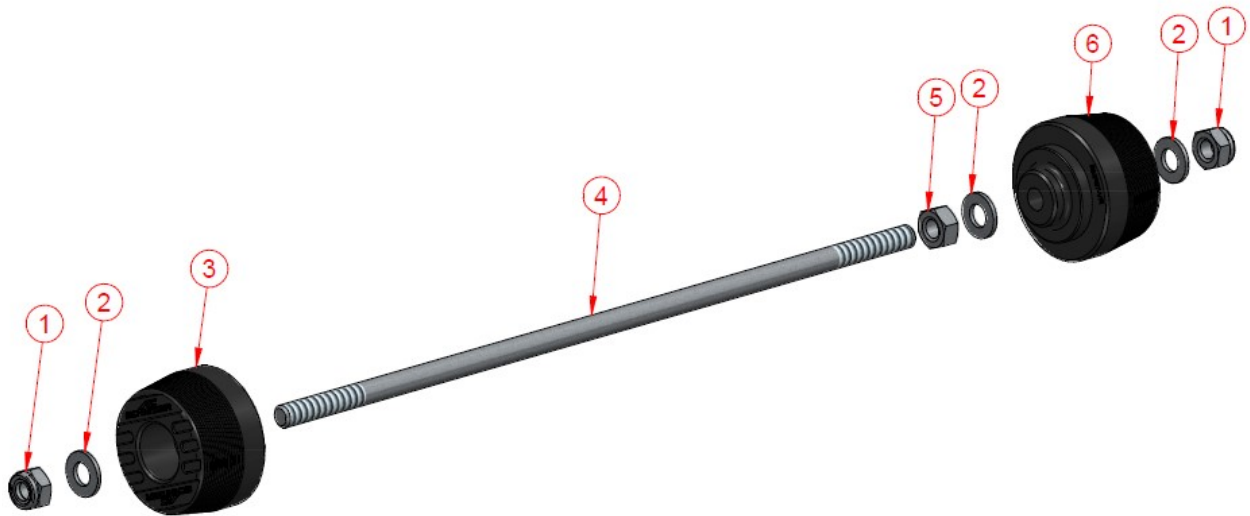

Pos.	Titel	Anzahl
1	Sechskantmutter DIN 985-M8	2
2	Scheibe DIN 125 - A 8,4	3
3	Achspad VL BMF9T	1
4	Achse Sturzpads VA BM1S	1
5	Sechskantmutter DIN 934 - M8	1
6	Achspad VR BMF9T	1

Assembly instruction number: S700398-F15 / Stood: 09.11.2020

AC Schnitzer - Motorradtechnik - Neuenhofstraße 160 - D - 52078 Aachen - Tel. 0241/5688 -300 Fax -135

Installation instructions



AC Schnitzer – F900R/XR –

Park the vehicle safely with a motorbike stand.



Clean the contact surfaces of the pads on the standpipe and on the axle on the left and the right.



Push the pre-assembled pad with the threaded rod from the right through the axle.

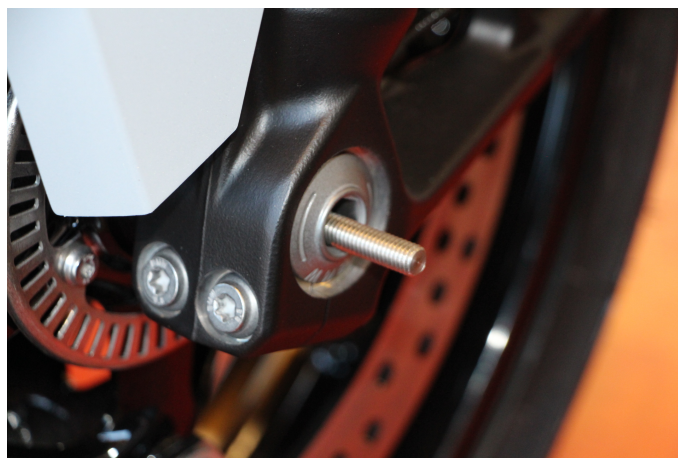

On the left side, fit the pad with the washer and nut.



Torque: 8 Nm

Assembly instruction number: S700398-F15 / Stood: 09.11.2020

AC Schnitzer - Motorradtechnik - Neuenhofstraße 160 - D - 52078 Aachen - Tel. 0241/5688 -300 Fax -135