

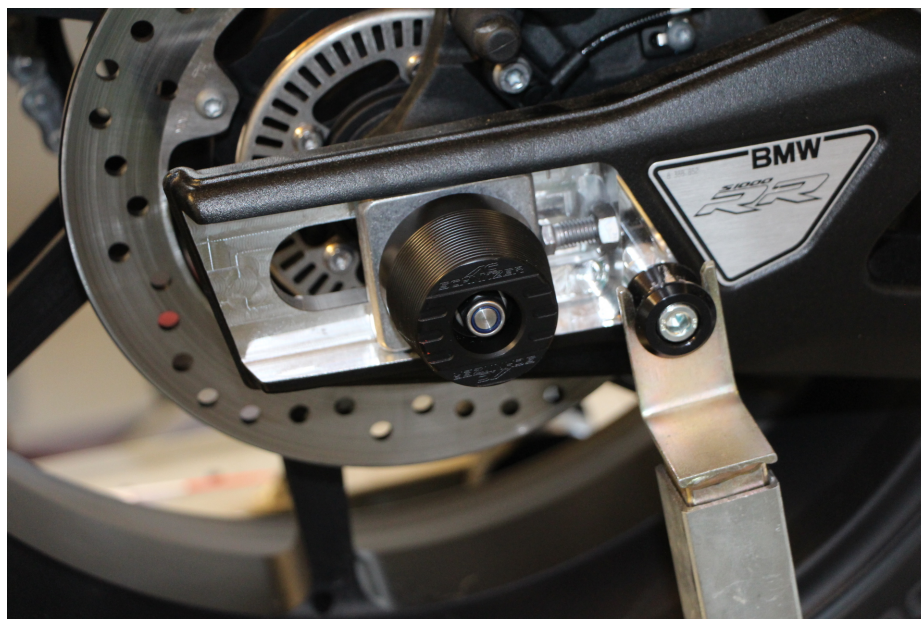

-Installation instructions-

Rear axle pads

- S 1000 RR from Modell 2010-**
- S 1000 R from Modell 2014-**
- S 1000 XR from Modell 2015-**
- F 900 R/XR from Modell 2020-**



Part number: S700373-F15

General notes!



AC Schnitzer

Important note!

It is essential to read these installation instructions **before** starting the installation work. AC Schnitzer accepts no liability whatsoever for damage caused by improper installation!

These installation instructions are intended exclusively for use by authorised AC Schnitzer or BMW dealers. The target group for these installation instructions is always specialist personnel trained on BMW vehicles with the appropriate specialist knowledge and tools. Knowledge regarding material properties and standards is assumed!

The crash pads offered by AC Schnitzer provide protection for the frame and the add-on parts in the event of "overturns" or so-called "slips". Unfortunately, even these components are no guarantee for accidents without consequential damage. So it is quite possible that the crash pads hook onto protruding parts such as curbs, manhole covers, kerbs, etc. during "slides" and give way to the force acting on them.

Any resulting consequential damage is the sole responsibility of the person who caused the fall and cannot be claimed from AC Schnitzer. Please inform your customers about this fact!

Mounting

All work must be carried out in accordance with the applicable safety regulations (e.g. protective goggles).

Paint

n/a

Installation time (1 AW = 5 minutes)

The installation time is approx. **1 AW**, which may vary depending on the condition and equipment of the vehicle

Paint (1 AW = 5 minutes)

n/a

Required tool

- 13mm socket spanner

Delivered components

AC Schnitzer

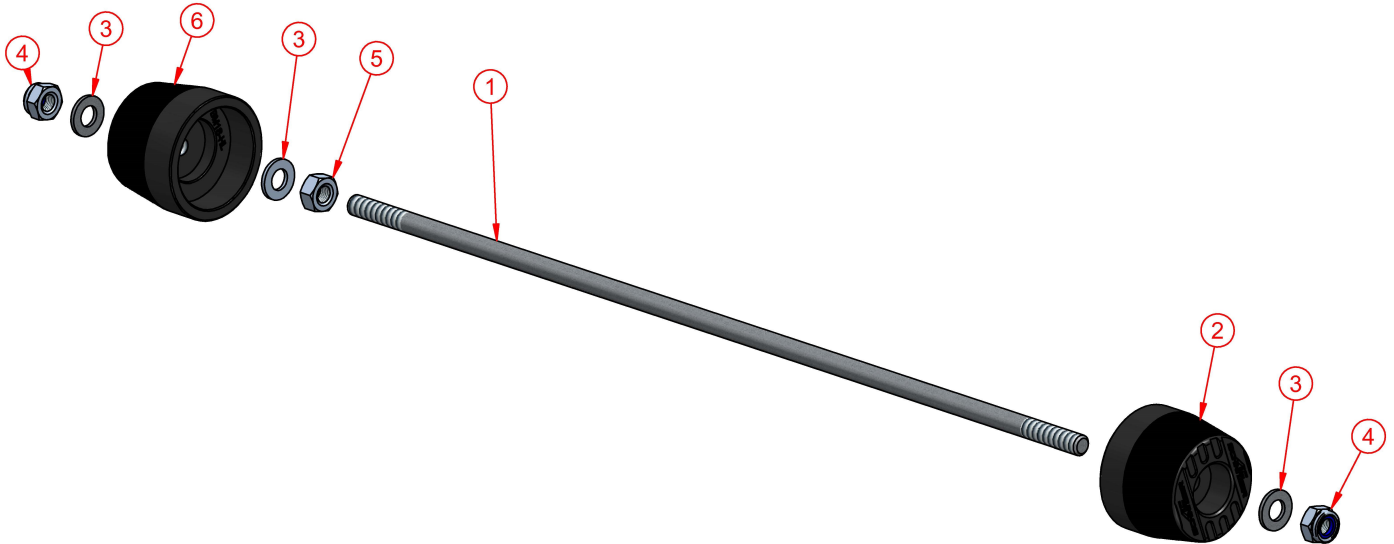

Pos.	Titel	Anzahl
1	Achse Sturzpads HA BM1S	1
2	Achspad HR BM1S	1
3	Scheibe DIN 125 - A 8,4	3
4	Sechskantmutter DIN 985-M8	2
5	Sechskantmutter DIN 934 - M8	1
6	Achspad HL BM1S	1

Installation instructions



AC Schnitzer

Park the vehicle safely with a motorbike stand.



Clean the contact surfaces of the pads on the swingarm and on the axle on the left and the right.



Push the pre-assembled pad with rod from the left through the axle.

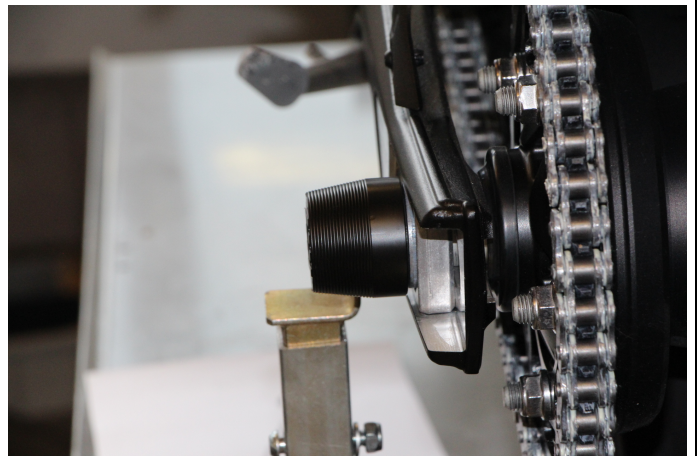

From the right side, mount the pad with the washer and nut.
Torque: 10 Nm



Assembly instruction number: S700373-F15 / Stood: 28.07.2020

AC Schnitzer - Motorradtechnik - Neuenhofstraße 160 - D - 52078 Aachen - Tel. 0241/5688 -300 Fax -135