

# **AC SCHNITZER**

## **-Fitting Instructions-**



## **Hand Lever Type AC S II**

# General Notes!



## AC Schnitzer Hand Lever AC S II

### Important Notes!

#### Important Notes!

These Fitting Instructions must be read carefully before starting work, and do not claim to be complete in relation to every work step. Technical, editorial and content changes are reserved!! AC Schnitzer bears no liability for damage caused by incorrect installation!

Check goods for completeness and absence of damage before starting work.

Later complaints cannot be accepted.

These Fitting Instructions are intended solely for use by authorised AC Schnitzer or BMW dealers. These Fitting Instructions are in all cases directed at professionals trained in BMW vehicles who have the corresponding specialist knowledge and tools. Knowledge concerning material properties and standards is assumed! Work on hydraulic systems, brake systems and the electrical system should only be carried out by trained personnel.

#### Before installation:

For installation, protect the vehicle adequately against rolling away or falling over.

We recommend the use of the normal main stand or an original BMW assembly stand! Keep children and animals away from the working area!

There is a risk of accident from tripping or electrical short-circuit! Therefore remove all jewellery (chains, watches, rings etc.) before starting work.

#### After installation:

After completion of the work, carry out a test ride. After the test ride, check all bolt connections for tightness and ensure that all moving parts have adequate clearance.

#### Fitting time (1 unit = 5 minutes )

The fitting time is around 5-8 units , which may vary depending on vehicle type.

(This value is a recommendation only and is not binding!)

#### Tools Required

- Standard automotive Torx driver
- Standard automotive Allen keys
- Screw locking paint
- Medium-strength thread lock
- Hot air gun

# Contents



## AC Schnitzer Hand Lever AC S II

Chapter	Page
1. Components supplied	4
2. <u>Fitting the AC Schnitzer hand lever to BMW K1200/1300R/S models</u>	5
3. <u>Fitting the AC Schnitzer hand lever to BMW F800R/GS/S models</u>	11
4. <u>Fitting the AC Schnitzer hand lever to BMW S 1000 R / RR models</u>	18
5. <u>Fitting the AC Schnitzer hand lever to BMW R 1200 models</u>	23
6. <u>Fitting the AC Schnitzer hand lever to BMW S 1000 XR models</u>	32
7. Fitting the AC Schnitzer hand lever to BMW Scrambler models	40

# Components Supplied



## AC Schnitzer Hand Lever AC S II

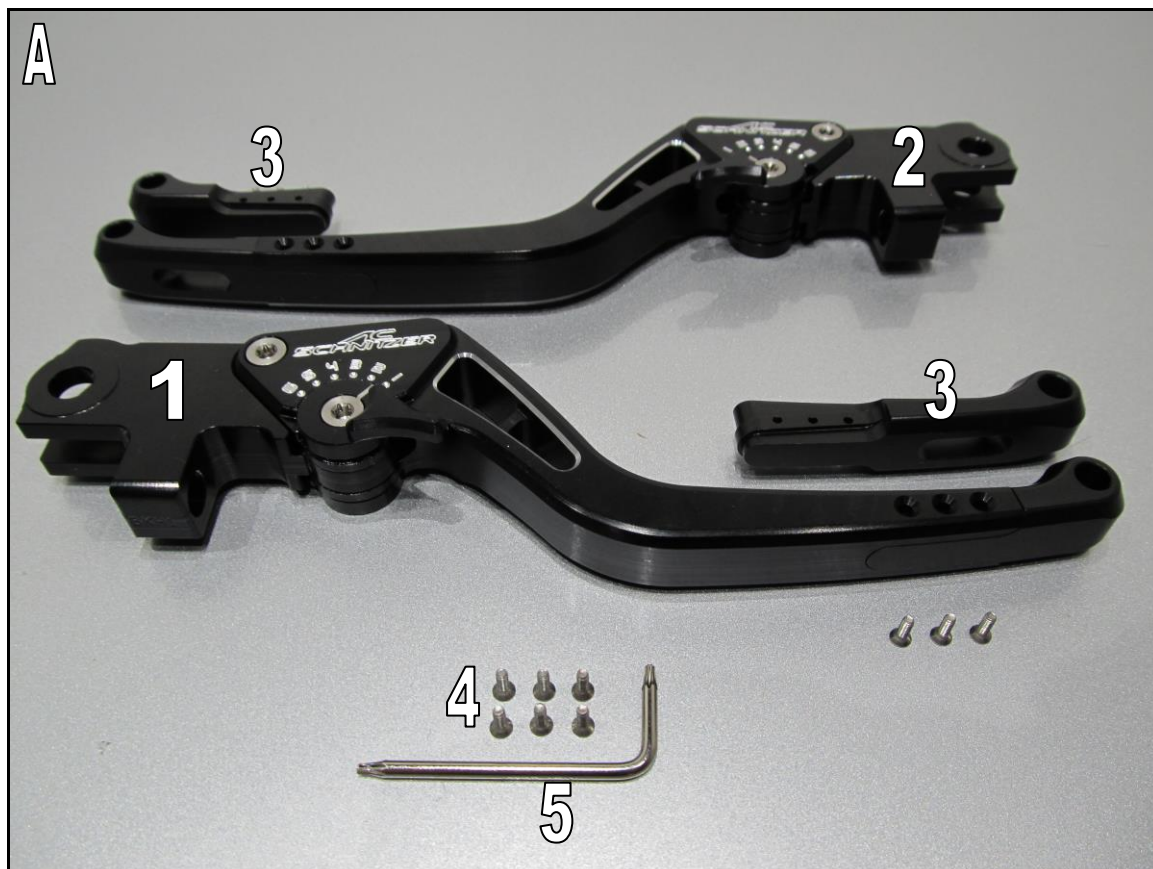

### **A** AC Schnitzer hand lever (vehicle-specific)

1. Brake control lever
2. Clutch control lever
3. 1 long and 1 short extension (per lever)
4. 6 fixing bolts (per lever)
5. 1 Torx angle driver (only when a set is ordered)

# **AC SCHNITZER**

## **-Fitting Instructions-**



**Hand Lever Type AC S II  
on BMW K 1200 / 1300 S/R**

# Fitting Instructions

**AC  
SCHNITZER**

## AC Schnitzer Hand Lever AC S II - General Notes -

### 2. - General Notes -

- **Before starting** work, park the vehicle safely and secure against falling or rolling away.
- **After completing** the work, carry out a test ride and check that the hand levers and electrical system (clutch switch / brake light switch / GRA switch and lighting system) function properly.
- A general operating licence is supplied with the AC Schnitzer hand lever type ACS2. This must be given to the customer with the information that these documents **must be carried on every ride!**

- The AC Schnitzer hand levers have 6 settings. The current position can be seen from the line marking. (Fig. 1) To adjust, press the hand lever slightly forward (in direction of travel), and turn the adjustment lever clockwise/counter-clockwise as required. AC Schnitzer recommends that adjustments are only performed when parked. In all cases, ensure there is **sufficient remaining travel** on operation. AC Schnitzer bears no liability for damage resulting from incorrect installation and lack of remaining travel!

- Before mounting on the vehicle, install the long or short extension (1 long & 1 short supplied per lever) using the fixing bolts supplied. For this, from the outside insert the desired extension flush into the guide of the lever concerned, and secure with 6 bolts per lever.
- Warning: Do not overtighten bolts!

?





# Fitting Instructions



## AC Schnitzer Hand Lever AC S II

### 2. Fitting

On brake side:

- Release and remove fixing bolt by releasing the fixing nut on the underside.
- Remove brake lever to the outside, being careful of the rubber sleeve. (Fig. 4)



- Using a suitable tool, e.g. Torx driver, press the plain bush out of the brake lever.

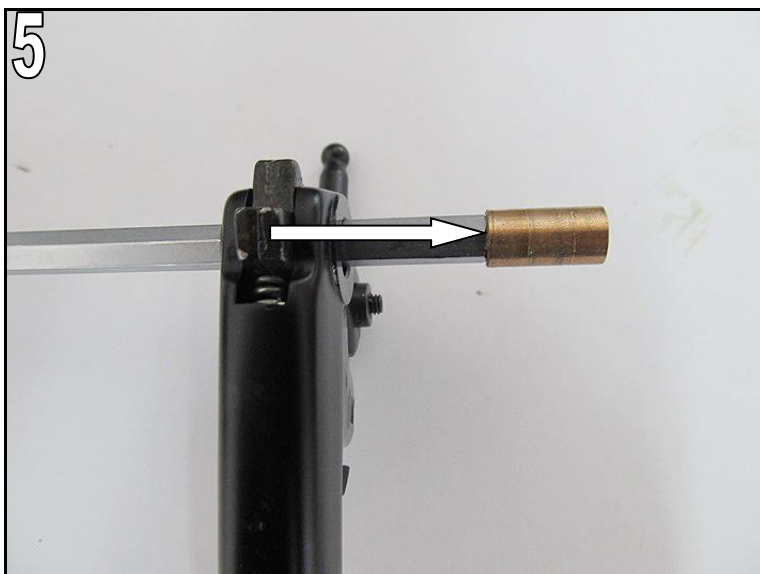

- Remove individual parts from brake lever.
- Warning: Parts are spring-loaded (Fig. 5)

- Clean components, inspect and grease lightly.

On vehicles BEFORE / UP TO MY 2011, remove standard rotary adjuster by twisting off the threaded piece.

On vehicles AFTER MY 2011, use the threaded insert 420-47812-41 ordered separately.

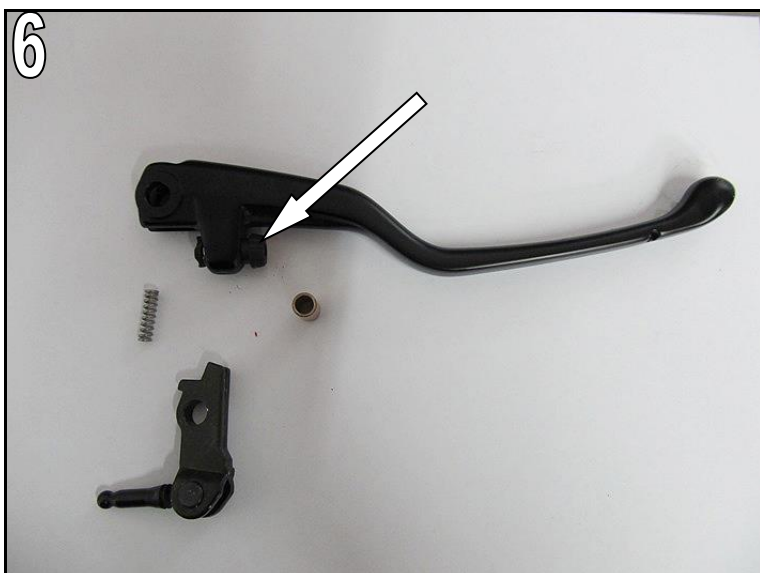

# Fitting Instructions



## AC Schnitzer Hand Lever AC S II

### 2. Fitting

- Clean standard rotary adjuster, grease lightly and screw into the AC Schnitzer brake lever. Vehicles before / up to 2011 (Fig. 7)



- On vehicles after 2011, lightly grease the separately ordered pressure piece and screw into the AC Schnitzer brake lever supplied as shown (Fig. 8).



- Refit the remaining components (push-rod and compression spring) to the AC Schnitzer brake lever in the reverse order from removal as shown, and fix using the standard bush.

Lightly grease ball on push-rod (Fig. 9)





# Fitting Instructions



## AC Schnitzer Hand Lever AC S II

### 2. Fitting

- Place prepared AC Schnitzer brake lever on the vehicle.
- Ensure that the ball of the push-rod perceptibly clicks into the cup provided in the brake fitting.
- Guide bolt through bush, and secure with new self-locking nut (7Nm)
- Make basic adjustment by screwing the pressure piece in (1.5 turns).

(Fig. 10)



- Remove fixing bolt by releasing and removing the fixing nut below the fitting. Remove fixing bolt towards the top. (Fig. 11)



- Press out bush using a suitable tool (Torx driver etc.) as shown.
- Warning: Parts are spring-loaded.

- Remove rotary adjuster by twisting off threaded piece. (Fig. 12)



Fitting Instructions Hand Lever Type AC S 2 / Issue: 19.01.2023 / TSch / REV02

AC Schnitzer - Neuenhofstraße 160 - D - 52078 Aachen - Tel. 0241/5688 -300 Fax -135 / [www.ac-schnitzer.de](http://www.ac-schnitzer.de)

# Fitting Instructions

**AC**  
**SCHNITZER**

## AC Schnitzer Hand Lever AC S II

### 2. Fitting

- Clean and lightly grease components
- Screw threaded piece into AC Schnitzer clutch lever supplied, clip rotary adjuster back on.
- Assemble cleaned and greased components as shown, and fix with standard bush.
- Lightly grease ball on push-rod. (Fig. 13)

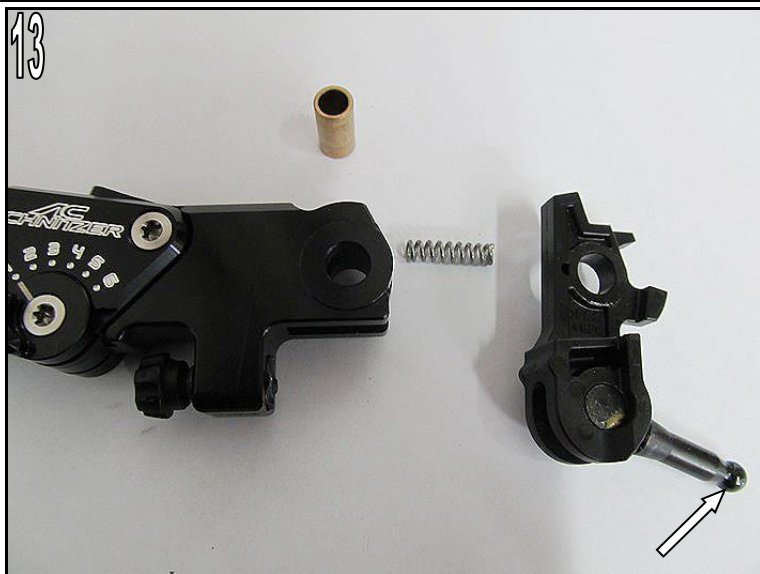

- Place prepared lever on clutch fitting, ensuring that the ball of the push-rod perceptibly engages in the cup of the piston seat. (Fig. 14)



- Guide bolt through bush, and secure with new self-locking nut (7Nm)
- Make basic adjustment by screwing the pressure piece in (1 turn).
- Ensure correct fitting!
- The general operating licence must be given to the customer.



Fitting Instructions Hand Lever Type AC S 2 / Issue: 19.01.2023 / TSch / REV02

AC Schnitzer - Neuenhofstraße 160 - D - 52078 Aachen - Tel. 0241/5688 -300 Fax -135 / [www.ac-schnitzer.de](http://www.ac-schnitzer.de)

# **AC SCHNITZER**

## **-Fitting Instructions-**



**Hand Lever Type AC S 2  
on BMW F 800 R/S/GS/GT**



# Fitting Instructions

**AC  
SCHNITZER**

## AC Schnitzer Hand Lever AC S II

### 2. Fitting

#### General Notes -

- **Before starting** work, park the vehicle safely and secure against falling or rolling away. (Fig. 1)
- **After completing** the work, carry out a test ride and check that the hand levers and electrical system (clutch switch / brake light switch / GRA switch and lighting system) function properly.
- A general operating licence is supplied with the AC Schnitzer hand lever type ACS II. This must be given to the customer with the information that these documents **must be carried on every ride!**

- The AC Schnitzer hand levers have 6 settings. The current position can be seen from the line marking. (Fig. 2) To adjust, press the hand lever slightly forward (in direction of travel), and turn the adjustment lever clockwise/counter-clockwise as required. AC Schnitzer recommends that adjustments are only performed when parked. In all cases, ensure there is **sufficient remaining travel** on operation. AC Schnitzer bears no liability for damage resulting from incorrect installation and lack of remaining travel!

- Before mounting on the vehicle, install the long or short extension (1 long & 1 short supplied per lever) using the fixing bolts supplied. For this, from the outside insert the desired extension flush into the guide of the lever concerned, and secure with 6 bolts per lever.
- Warning: Do not overtighten bolts! (Fig. 3)



Fitting Instructions Hand Lever Type AC S 2 / Issue: 19.01.2023 / TSch / REV02

AC Schnitzer - Neuenhofstraße 160 - D - 52078 Aachen - Tel. 0241/5688 -300 Fax -135 / [www.ac-schnitzer.de](http://www.ac-schnitzer.de)

# Fitting Instructions



## AC Schnitzer Hand Lever AC S II

### 2. Fitting

- On brake side:
- Release and remove the fixing nut on the underside. (Fig. 4)
- Remove fixing bolt upward from hand fitting.
- Remove brake lever towards the outside, being careful of the rubber sleeve. (Fig. 5)
- Using a suitable tool, e.g. Torx driver, press the plain bush out of the brake lever.
- Remove individual parts from brake lever.
- Warning: Parts are spring-loaded (Fig. 6)

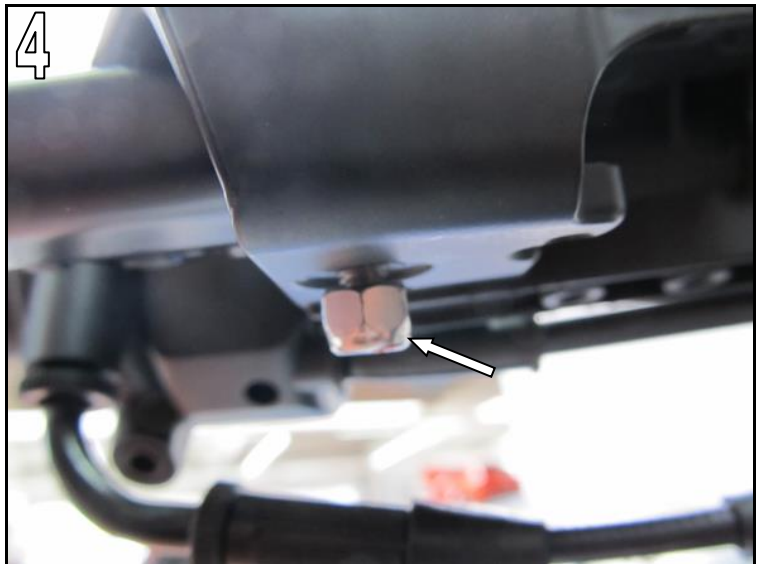



# Fitting Instructions



## AC Schnitzer Hand Lever AC S II

### 2. Fitting

-- Clean, inspect and lightly grease components.

On vehicles **BEFORE** / **UP TO** MY 2011, remove standard rotary adjuster by twisting off the threaded piece.

(Fig. 7)

On vehicles **AFTER** MY 2011, use the threaded insert 420-47812-41 ordered separately.

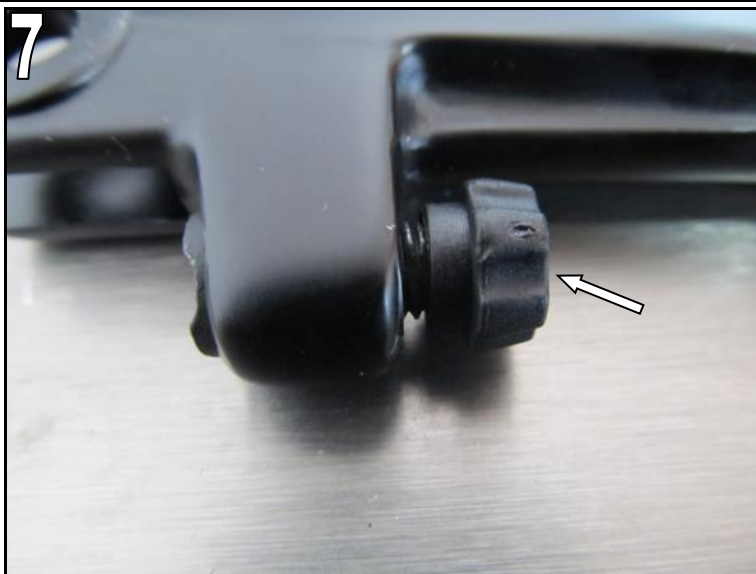

- Clean standard threaded piece, grease lightly and screw into the AC Schnitzer brake lever. Clip plastic rotary adjuster back onto threaded piece, as per standard.

(Vehicles up to 2011)

- On vehicles after 2011, lightly grease the separately ordered pressure piece and screw fully into the AC Schnitzer brake lever supplied as shown. (Fig. 8)

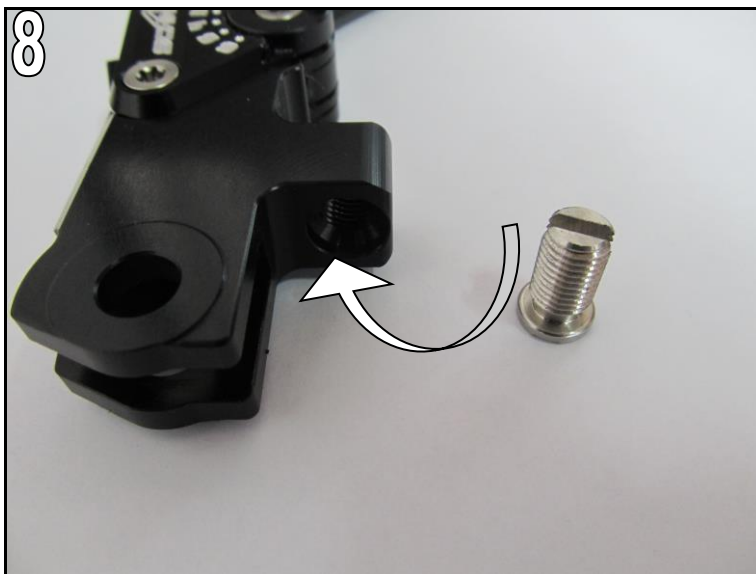

- Refit the remaining components (push rod and compression spring) to the AC Schnitzer brake lever in the reverse order from removal, as shown, and fix using the standard bush. Lightly grease ball on push-rod. (Fig. 9)

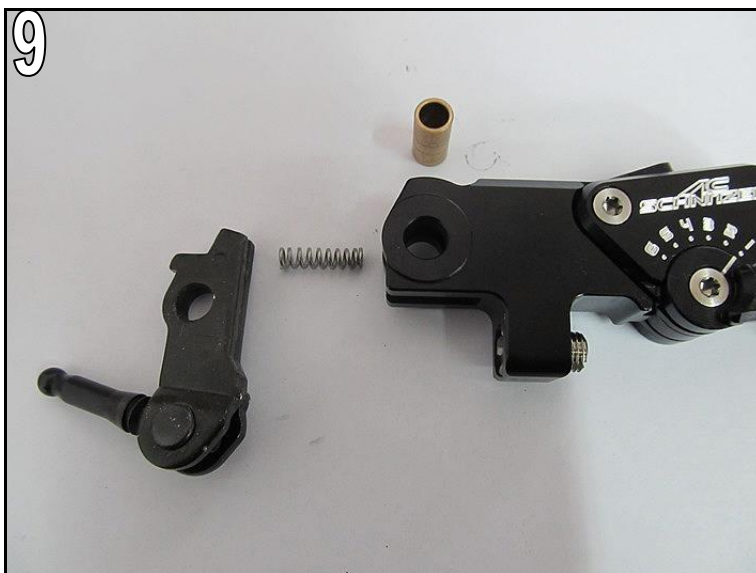

Fitting Instructions Hand Lever Type AC S 2 / Issue: 19.01.2023 / TSch / REV02

AC Schnitzer - Neuenhofstraße 160 - D - 52078 Aachen - Tel. 0241/5688 -300 Fax -135 / [www.ac-schnitzer.de](http://www.ac-schnitzer.de)

# Fitting Instructions



## AC Schnitzer Hand Lever AC S II

### 2. Fitting

- Place prepared AC Schnitzer brake lever on the vehicle.
  - Ensure that the ball of the push-rod perceptibly clicks into the cup provided in the brake fitting.
  - Guide bolt through bush, and secure with new self-locking nut (7Nm)
  - Make basic adjustment by screwing the pressure piece in (1.5 turns).
- (Fig. 10)



- On clutch side:

- Push the rubber sleeve of the cable adjustment away from the adjustment unit. (Fig. 11)



- Release plastic locknut fully by turning counter-clockwise.
- Screw in adjustment screw fully clockwise.
- Unthread clutch cable from clutch fitting. (Fig. 12)

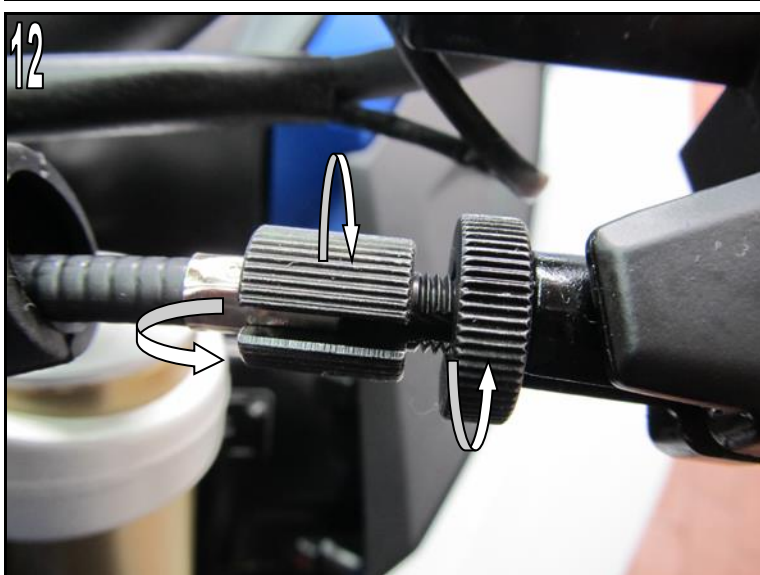

Fitting Instructions Hand Lever Type AC S 2 / Issue: 19.01.2023 / TSch / REV02

AC Schnitzer - Neuenhofstraße 160 - D - 52078 Aachen - Tel. 0241/5688 -300 Fax -135 / [www.ac-schnitzer.de](http://www.ac-schnitzer.de)

# Fitting Instructions



## AC Schnitzer Hand Lever AC S II

### 2. Fitting

- Release and remove the fixing nut on the clutch fitting. Remove fixing bolt toward the top. (Fig.13)



- Remove hand lever from vehicle.
- Press out bush with a suitable tool (e.g. Torx driver).
- Warning: Parts are spring-loaded.



- Clean and lightly grease components, and prepare for assembly as shown.
- Slide spring into the bore provided (Fig. 15).

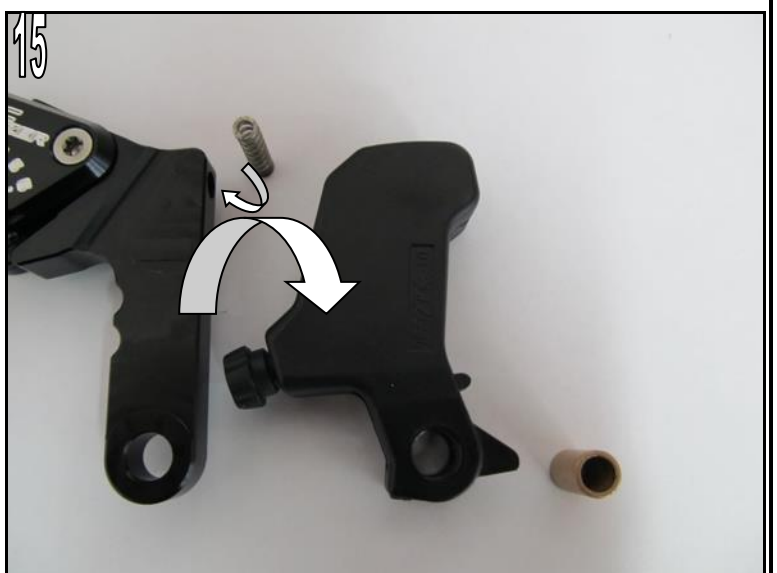

Fitting Instructions Hand Lever Type AC S 2 / Issue: 19.01.2023 / TSch / REV02

AC Schnitzer - Neuenhofstraße 160 - D - 52078 Aachen - Tel. 0241/5688 -300 Fax -135 / [www.ac-schnitzer.de](http://www.ac-schnitzer.de)



# Fitting Instructions

**AC  
SCHNITZER**

## AC Schnitzer Hand Lever AC S II

### 2. Fitting

- Assemble the joined clutch lever with the standard, lightly greased bush. (Fig. 16)



- Place prepared lever on standard clutch fitting, and secure using the standard bolt and a new fixing washer (7 Nm) (Fig.17).



- Rethread clutch cable and set clutch pull/play on left lock to 3mm play according to BMW specification. (Fig. 18)

- Ensure that the unit is correctly fitted!
- The general operating licence must be given to the customer.



Fitting Instructions Hand Lever Type AC S 2 / Issue: 19.01.2023 / TSch / REV02

AC Schnitzer - Neuenhofstraße 160 - D - 52078 Aachen - Tel. 0241/5688 -300 Fax -135 / [www.ac-schnitzer.de](http://www.ac-schnitzer.de)

# **AC SCHNITZER**

## **-Fitting Instructions-**



**Hand Lever Type AC S 2  
on BMW S 1000 R / RR**



# Fitting Instructions

**AC  
SCHNITZER**

## AC Schnitzer Hand Lever AC S II

### 2. Fitting

#### - General Notes -

- **Before starting** work, park the vehicle safely and secure against falling or rolling away. (Fig. 1)
- **After completing** the work, carry out a test ride and check that the hand levers and electrical system (clutch switch / brake light switch / GRA switch and lighting system) function properly.
- A general operating licence is supplied with the AC Schnitzer hand lever type ACS2. This must be given to the customer with the information that these documents **must be carried on every ride!**

- The AC Schnitzer hand levers have 6 settings. The current position can be seen from the line marking. (Fig. 2) To adjust, press the hand lever slightly forward (in direction of travel), and turn the adjustment lever clockwise/counter-clockwise as required. AC Schnitzer recommends that adjustments are only performed when parked. In all cases, ensure there is **sufficient remaining travel** on operation. AC Schnitzer bears no liability for damage resulting from incorrect installation and lack of remaining travel!

- Before mounting on the vehicle, install the long or short extension (1 long & 1 short supplied per lever) using the fixing bolts supplied. For this, from the outside insert the desired extension flush into the guide of the lever concerned, and secure with 6 bolts per lever.
- Warning: Do not overtighten bolts! (Fig. 3)



# Fitting Instructions

**AC  
SCHNITZER**

## AC Schnitzer Hand Lever AC S II

### 2. Fitting the brake lever

- On the brake lever side: From below, release and remove lock nut (SW 10) on the fixing bolt. Unscrew and remove fixing bolt. Remove standard brake lever forward from the hand pump. (Fig. 4)

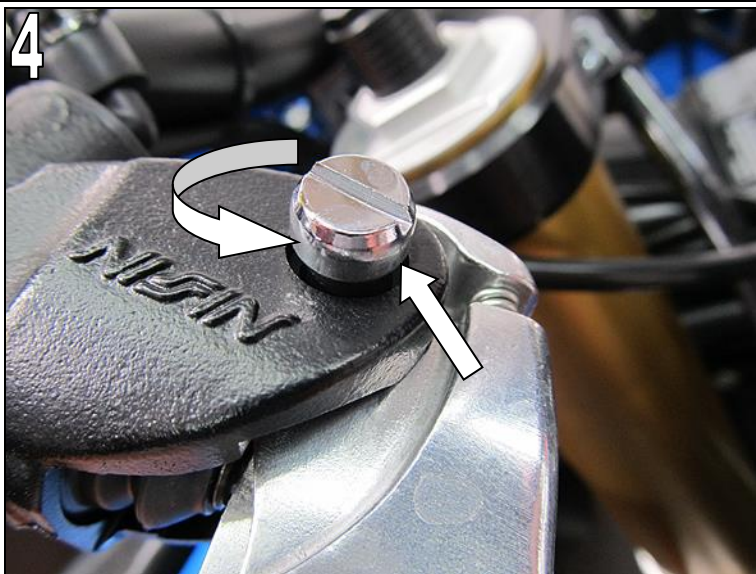

- Lightly grease the bore of the prepared AC Schnitzer brake lever and the bore for the push bolt. (Fig. 5)

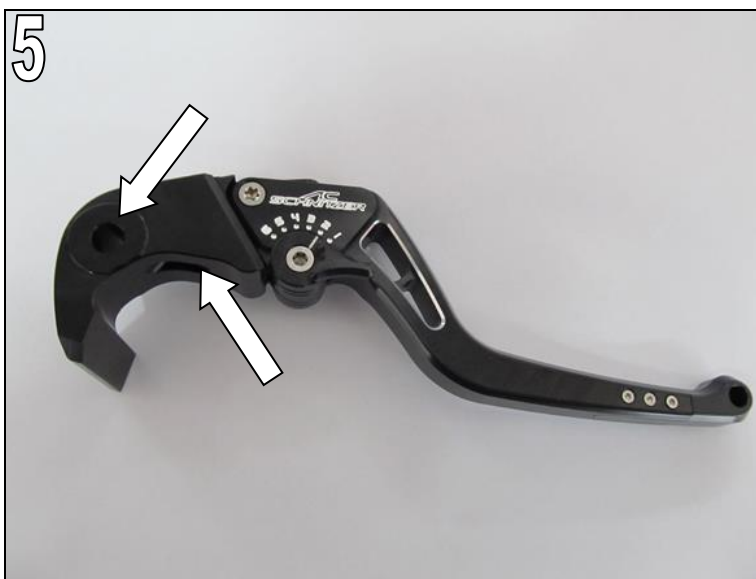

- Place AC Schnitzer lever on the vehicle, ensuring that the push bolt of the pump slides in the lever deflection. Screw in fixing bolt again and secure (1Nm). The attach (new) fixing nut onto fixing bolt (6Nm), counter-holding the fixing bolt. (Fig. 6)



Fitting Instructions Hand Lever Type AC S 2 / Issue: 19.01.2023 / TSch / REV02

AC Schnitzer - Neuenhofstraße 160 - D - 52078 Aachen - Tel. 0241/5688 -300 Fax -135 / [www.ac-schnitzer.de](http://www.ac-schnitzer.de)



# Fitting Instructions

## AC Schnitzer Hand Lever AC S II

### 2. Fitting the clutch lever

- Screw in knurled knob of cable adjustment as far as possible to relieve the tension on the cable. Ensure that the slot in the knurled knob stands parallel to the slot in the fitting. (Fig. 7)



- Remove clutch cable from hand fitting and standard clutch lever. (Fig. 8)



- Release standard lock nut at fixing bolt, and remove together with washer. Remove fixing bolt toward the top. Remove standard lever. (Fig. 9)

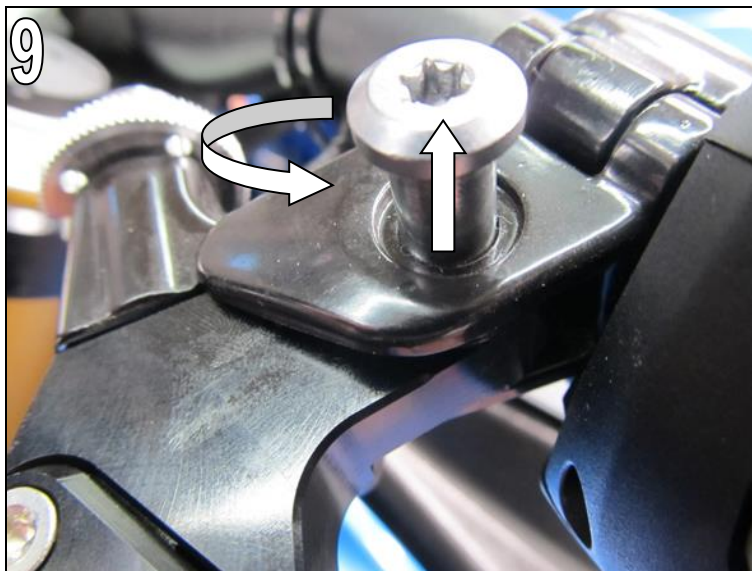

# Fitting Instructions

**AC  
SCHNITZER**

## AC Schnitzer Hand Lever AC S II

### 2. Fitting

- S 1000 RR up to model year 2014 & from model 2019 use the original bushing of the standard clutch lever. Squeeze it out, lightly grease it and press it into the AC Schnitzer lever.

S 1000 RR My. 2015 to 2018 (S 1000 R from '14)

- Lightly grease the enclosed sliding bush and push it into the hole of the adapter.

(Fig. 10)

#### Not applicable for model from 2019

- On the back of the standard lever, dismantle microswitch pusher and remove pusher. Place standard pusher in the same position on the AC Schnitzer lever and tighten using the fixing screw supplied. (Fig. 11)

Insert lever in the standard fitting. Screw in fixing bolt. From below, fit washer and (new) M6 nut and secure (6Nm), counter-holding the fixing bolt.

- Connect clutch cable and pretension knurled knob. Set clutch play according to BMW specification with cold engine, ensuring that the clutch play is present in all handlebar positions.

- Check for correct function of microswitch. (Both microswitches must audibly switch.

(Fig. 12)

- With the clutch lever pulled, the headlamp flasher switch must not operate. If necessary, loosen the fitting and twist accordingly.

- Then carry out a test ride and check the function of the electrical system (brake light etc.).

- Ensure correct fitting!

- The general operating licence must be given to the customer.

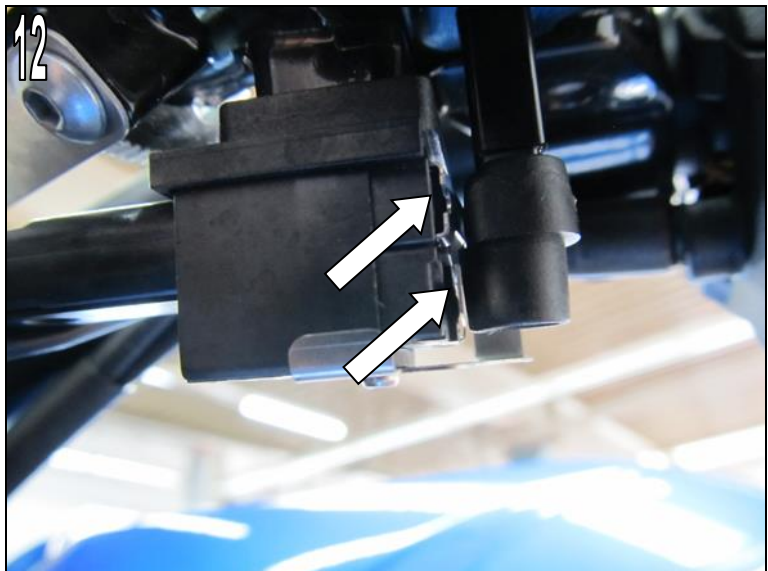

Fitting Instructions Hand Lever Type AC S 2 / Issue: 19.01.2023 / TSch / REV02

AC Schnitzer - Neuenhofstraße 160 - D - 52078 Aachen - Tel. 0241/5688 -300 Fax -135 / [www.ac-schnitzer.de](http://www.ac-schnitzer.de)

# **AC SCHNITZER**

## **-Fitting Instructions-**



## **Hand Lever Type AC S 2**

**on BMW R 1200 GS / R / RS (LC)**



# Fitting Instructions

**AC  
SCHNITZER**

## AC Schnitzer Hand Lever AC S II

### 2. Fitting

#### - General Notes -

- **Before starting** work, park the vehicle safely and secure against falling or rolling away. (Fig. 1)
- **After completing** the work, carry out a test ride and check that the hand levers and electrical system (clutch switch / brake light switch / GRA switch and lighting system) function properly.
- A general operating licence is supplied with the AC Schnitzer hand lever type ACS2. This must be given to the customer with the information that these documents **must be carried on every ride!**

- The AC Schnitzer hand levers have 6 settings. The current position can be seen from the line marking. (Fig. 2) To adjust, press the hand lever slightly forward (in direction of travel), and turn the adjustment lever clockwise/counter-clockwise as required. AC Schnitzer recommends that adjustments are only performed when parked. In all cases, ensure there is **sufficient remaining travel** on operation. AC Schnitzer bears no liability for damage resulting from incorrect installation and lack of remaining travel!

- Before mounting on the vehicle, install the long or short extension (1 long & 1 short supplied per lever) using the fixing bolts supplied. For this, from the outside insert the desired extension flush into the guide of the lever concerned, and secure with 6 bolts per lever.
- Warning: Do not overtighten bolts! (Fig. 3)



# Fitting Instructions

**AC  
SCHNITZER**

## AC Schnitzer Hand Lever AC S II

### 2. Fitting the brake lever

- R 1200 GS only:

On both sides, push up the rubber sleeve over the rear-view mirror fixing and release the rear-view mirror by twisting counter-clockwise; remove from vehicle. (Fig. 4)



- R 1200 GS only: On both sides of the vehicle, release the outer fixing bolt of the hand guards, then remove hand guards from vehicle. (Fig. 5)



- Release and remove the fixing nut on the hand lever. (Fig. 6)



## AC Schnitzer Hand Lever AC S II

### 2. Fitting the brake lever

- To release the fixing nut, counter-hold the fixing bolt from above. Remove fixing bolt upward from hand fitting.

Warning: The left and right fixing bolts are different, do not mix up! (Fig.7)



- Transfer position of grub screw to pressure piece and retaining bolt.

- Then heat grub screw (hot air gun), loosen and remove

- Unscrew pressure piece from retaining bolt counter-clockwise, counting and recording the number of turns. (Fig. 8)

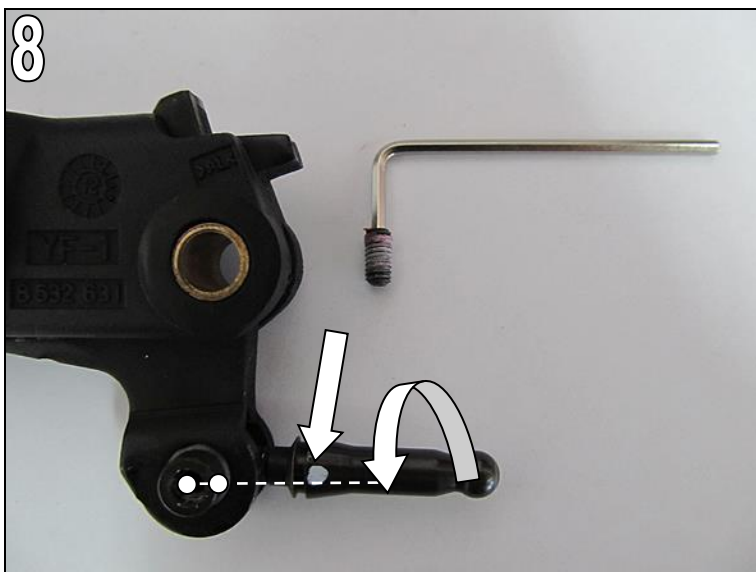

- Press bearing bush out of standard hand lever, and remove.

- Warning: bearing is spring-loaded.

- Clean and grease bearing bush lightly. (Fig. 9)





# Fitting Instructions



## AC Schnitzer Hand Lever AC S II

### 2. Fitting the brake lever

- Mark imprint of grub screw on thread. (Fig. 10)

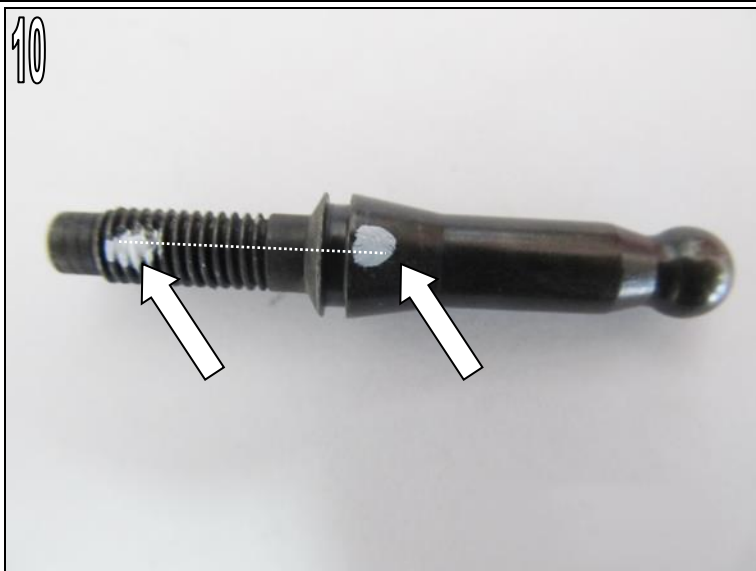

- Screw retaining bolt in the identical position in the AC Schnitzer brake lever supplied.
- Screw in pressure bolt clockwise, counting the turns and comparing with recorded values.
- Then look through the fixing hole and check that the marking on the thread of the pressure bolt can be seen through the hole.
- Coat grub screw lightly with medium-strength thread lock, screw in and tighten.
- Then seal the hex head of the grub screw with screw locking paint (Fig. 11).

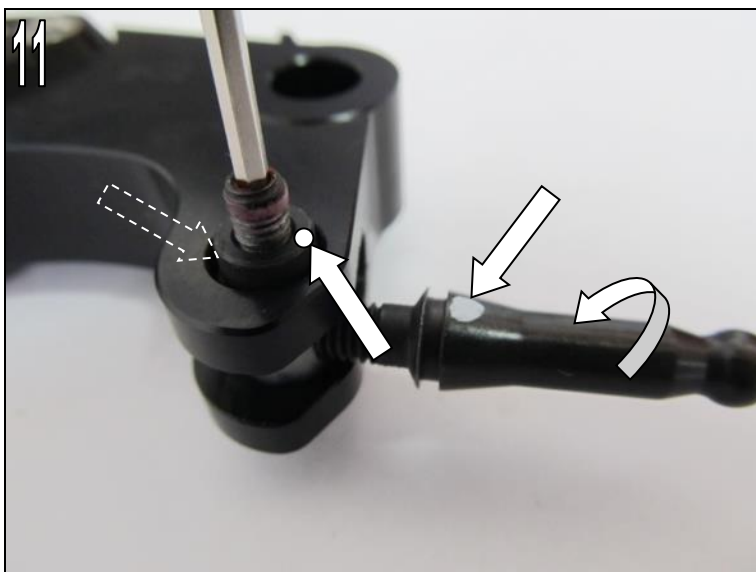

- Push lightly greased bearing bush into the AC Schnitzer lever supplied. (Fig. 12)



# Fitting Instructions

**AC  
SCHNITZER**

## AC Schnitzer Hand Lever AC S II

### 2. Fitting the brake lever

- Place prepared brake lever on vehicle, the ball of the pressure bolt must engage perceptibly in the cup.
- From above, push fixing bolt (ensure correct one) through the hand fitting and bearing bush, and secure from below with a new self-locking nut.
- Seal self-locking nut with screw locking paint (Fig. 13)



- R 1200 GS only: Refit standard hand guard to original position. To do this, lightly coat the fixing bolts with medium-strength thread lock.



- Ensure that the brake system does not build up a prepressure from the pressure bolt not being correctly engaged; check air gap, if necessary on test ride. (Fig. 14)

- Proceed on clutch side in the same way as on brake side:
- Release and remove the fixing nut. (Fig.15)



Fitting Instructions Hand Lever Type AC S 2 / Issue: 19.01.2023 / TSch / REV02

AC Schnitzer - Neuenhofstraße 160 - D - 52078 Aachen - Tel. 0241/5688 -300 Fax -135 / [www.ac-schnitzer.de](http://www.ac-schnitzer.de)



# Fitting Instructions



## AC Schnitzer Hand Lever AC S II

### 2. Fitting the clutch lever

- Remove fixing bolt upward from hand fitting.
- Remove hand lever from fitting (Fig. 16)



- Transfer position of grub screw to retaining bolt and pressure piece, heat grub screw (hot air fan), loosen and remove.
- Unscrew pressure piece from retaining bolt counter-clockwise, counting and recording the number of turns. (Fig. 17)

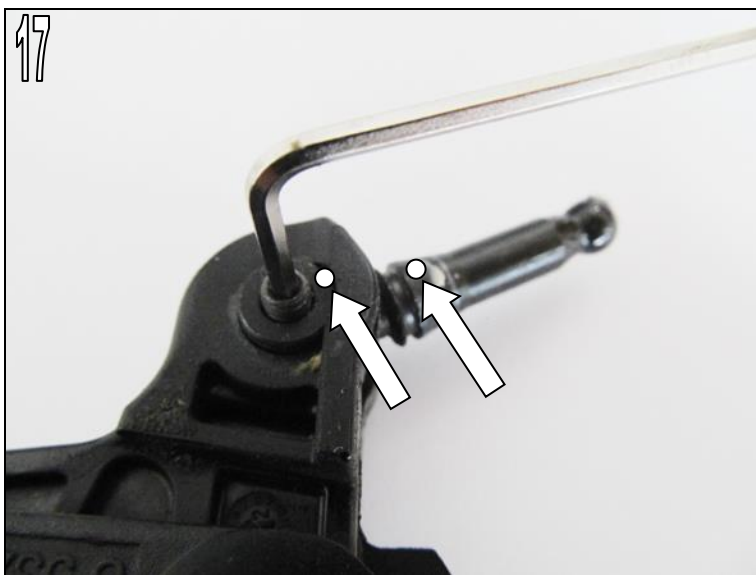

- Mark imprint of grub screw on thread of pressure piece. (Fig. 18)



# Fitting Instructions



## AC Schnitzer Hand Lever AC S II

### 2. Fitting the clutch lever

- Push retaining bolt with marking into the AC Schnitzer clutch lever as shown, turn pressure piece clockwise by the number of turns previously noted.
- Then look through the fixing hole and check that the marking on the thread of the pressure bolt can be seen through the hole.
- Coat grub screw lightly with medium-strength thread lock, screw in and tighten.
- Then seal the hex head of the grub screw with screw locking paint. (Fig. 19)



- Clean bearing bush, grease lightly and insert in the bore of the AC Schnitzer clutch lever. (Fig. 20)



- Lightly grease ball head (!). (Fig. 21)



## AC Schnitzer Hand Lever AC S II

### 2. Fitting the clutch lever

- Place prepared clutch lever on vehicle, the ball of the pressure bolt must engage perceptibly in the cup.
- From above, push fixing bolt (ensure correct bolt) through the hand fitting and bearing bush. (Fig. 22).



- From below, secure fixing bolt with a new self-locking nut.
- Seal self-locking nut with screw locking paint. (Fig. 23)



- Ensure that the clutch system does not build up a prepressure from the pressure bolt not being correctly engaged; check air gap.

- Final work:
- Function test of lighting system, especially the brake light.
- Function test of all microswitches present on the hand levers.
- Carry out test ride
- Check function of brake and clutch system
- Give customer the operating licence



# **AC SCHNITZER**

## **-Fitting Instructions-**



## **Hand Lever Type AC S 2**

**on BMW S 1000 XR**

# Fitting Instructions

**AC**  
**SCHNITZER**

## AC Schnitzer Hand Lever AC S II

### 2. Fitting

#### - General Notes -

- **Before starting** work, park the vehicle safely and secure against falling or rolling away. (Fig. 1)
- **After completing** the work, carry out a test ride and check that the hand levers and electrical system (clutch switch / brake light switch / GRA switch and lighting system) function properly.
- A general operating licence is supplied with the AC Schnitzer hand lever type ACS2. This must be given to the customer with the information that these documents **must be carried on every ride!**

- The AC Schnitzer hand levers have 6 settings. The current position can be seen from the line marking. (Fig. 2) To adjust, press the hand lever slightly forward (in direction of travel), and turn the adjustment lever clockwise/counter-clockwise as required. AC Schnitzer recommends that adjustments are only performed when parked. In all cases, ensure there is **sufficient remaining travel** on operation. AC Schnitzer bears no liability for damage resulting from incorrect installation and lack of remaining travel!

- Before mounting on the vehicle, install the long or short extension (1 long & 1 short supplied per lever) using the fixing bolts supplied. For this, from the outside insert the desired extension flush into the guide of the lever concerned, and secure with 6 bolts per lever.

- Warning: Do not overtighten bolts!  
(Fig. 3)



# Fitting Instructions



## AC Schnitzer Hand Lever AC S II

### 2. Fitting the brake lever

- Remove the hand guard (SA) where fitted by releasing the Torx bolt, removing this and removing the handlebar weight and spacer. (Fig. 4)



- Push mirror bolt rubber cap upward. Release fixing for the standard rear-view mirror (SW14) and remove mirror. Remove aluminium plate and hand guard from vehicle. (Fig. 5)

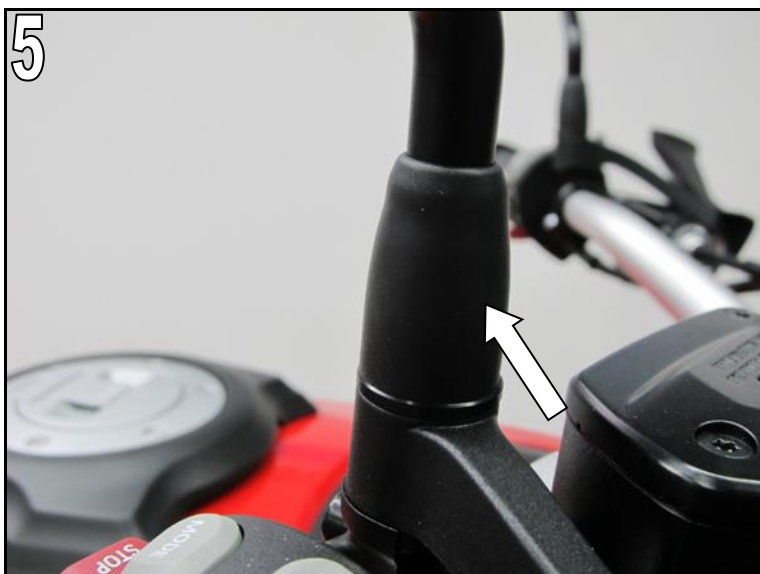

- From below: Release fixing nut (SW 10) and remove. (Fig. 6)



Fitting Instructions Hand Lever Type AC S 2 / Issue: 19.01.2023 / TSch / REV02

AC Schnitzer - Neuenhofstraße 160 - D - 52078 Aachen - Tel. 0241/5688 -300 Fax -135 / [www.ac-schnitzer.de](http://www.ac-schnitzer.de)



# Fitting Instructions



## AC Schnitzer Hand Lever AC S II

### 2. Fitting the brake lever

- From above: Release slot screw and remove from hand fitting. Remove hand lever from fitting. (Fig. 7)

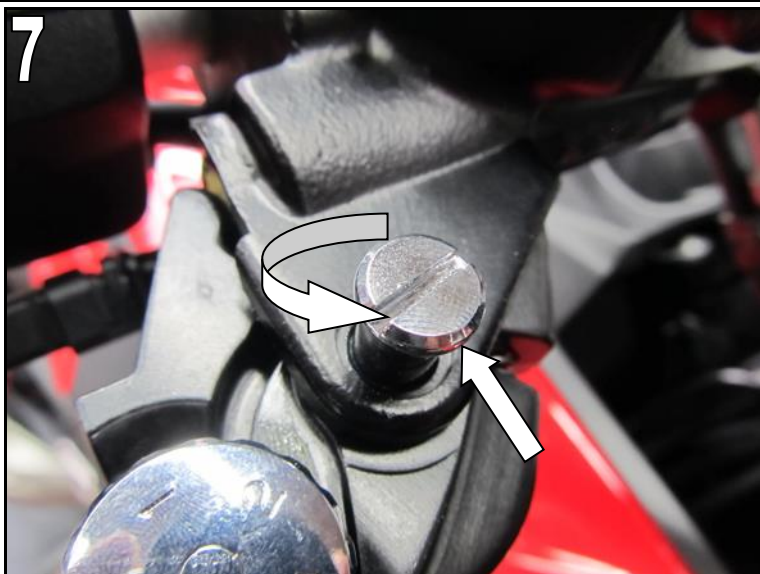

- Lightly grease bush and contact point on hand lever supplied, and place AC Schnitzer hand lever on the standard fitting. Position standard fixing bolt and screw in (1 Nm). (Fig. 8)



- From below: Position standard fixing nut on bolt already screwed in, and secure while holding the bolt from above (6Nm). (Fig.9)  
- Refit the hand guard to the vehicle, and re-attach with mirror and handlebar weight.



Fitting Instructions Hand Lever Type AC S 2 / Issue: 19.01.2023 / TSch / REV02

AC Schnitzer - Neuenhofstraße 160 - D - 52078 Aachen - Tel. 0241/5688 -300 Fax -135 / [www.ac-schnitzer.de](http://www.ac-schnitzer.de)

# Fitting Instructions

**AC**  
**SCHNITZER**

## AC Schnitzer Hand Lever AC S II

### 2. Fitting the clutch lever

- Remove the hand guard on the clutch side, where fitted. Proceed as for brake side. (Fig. 10)

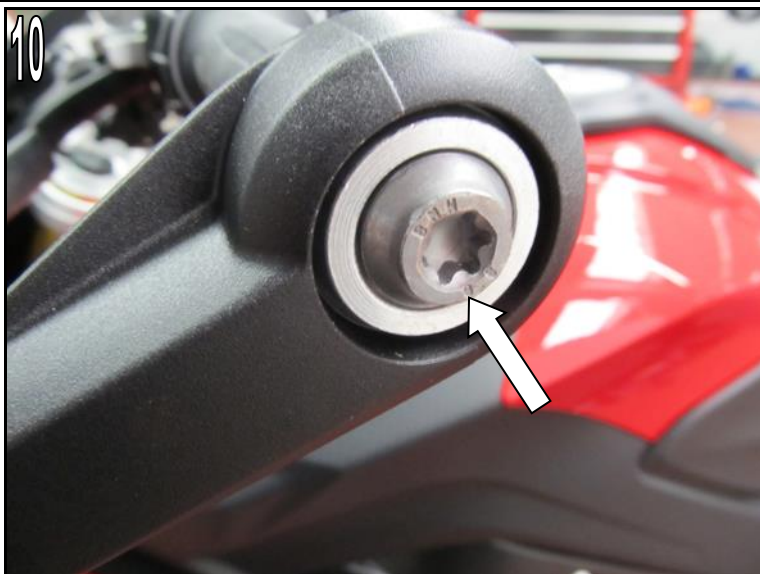

- Pull clutch lever and secure in the tensioned position using the 19-size fork wrench adjuster on the engine. (Fig. 11)

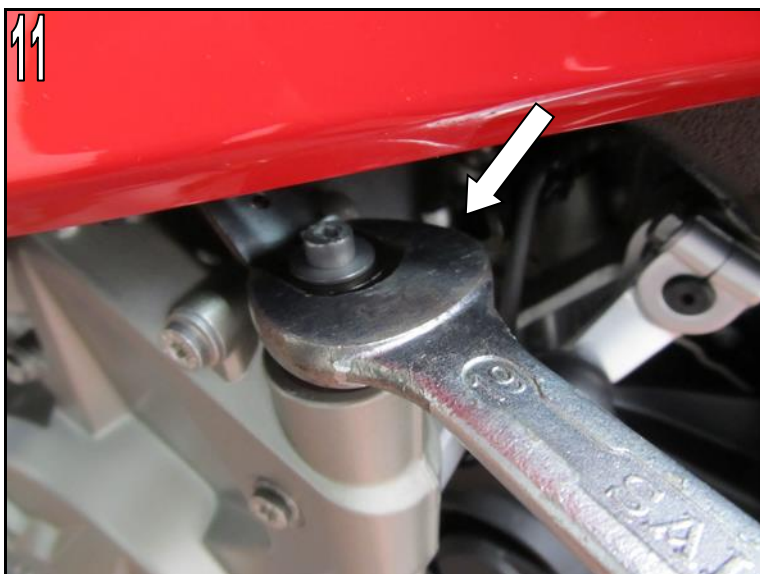

- Release Bowden cable from adjuster and hand lever. (Fig. 12)



# Fitting Instructions

**AC  
SCHNITZER**

## AC Schnitzer Hand Lever AC S II

### 2. Fitting the clutch lever

- From below: Release fixing nut and remove nut and washer.
- From above: Release Torx fixing bolt and unscrew, remove standard lever from vehicle. (Fig. 13)



- On the underside of the standard clutch lever, unscrew the Torx bolt on the switch control and remove the switch control from the hand lever. (Fig. 14)

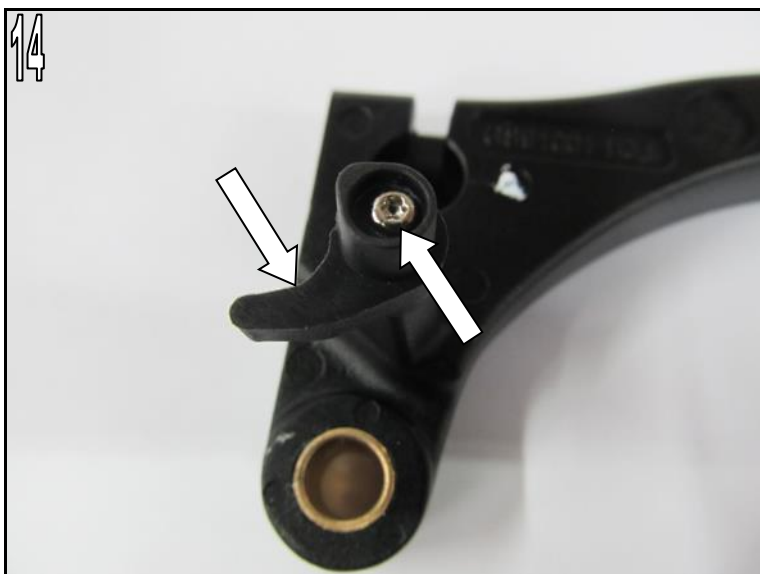

- Place the standard switch control in the same position on the AC Schnitzer clutch lever supplied, and secure with the standard screw. (Fig. 15)





# Fitting Instructions

**AC  
SCHNITZER**

## AC Schnitzer Hand Lever AC S II

### 2. Fitting the clutch lever

- Lightly grease the bush supplied on the inside and outside, and push into the rotary point of the AC Schnitzer hand lever. (Fig. 16)



- Place the prepared hand lever on the standard clutch fitting, and secure with the Torx bolt (1Nm). From below: Place the standard washer and nut on the Torx bolt and tighten. 6Nm)



- Slightly pretension the adjuster on the gearbox using the size 19 spanner, and connect the cable to the hand lever.  
- If necessary, adjust the clutch play according to BMW specifications at the knurled wheel when the engine is cold. (Fig. 18)



# Fitting Instructions



## AC Schnitzer Hand Lever AC S II

### 2. Fitting the clutch lever

- Check that there is sufficient clearance from the standard headlight switch with the AC Schnitzer hand lever in position "1". If necessary, loosen the clutch fitting on the handlebar and turn down slightly. (Fig. 19)



- Refit any hand guards to the vehicle and secure. (Fig. 20)

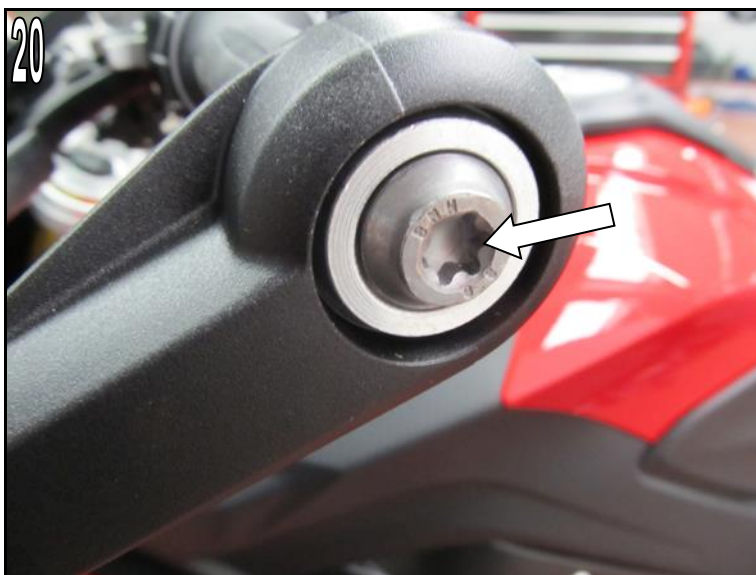

- Screw the standard mirror to the clutch fitting and secure. (Fig. 21)

Ensure that the microswitch(es) on the clutch control operate perfectly.

When riding, ensure there is sufficient separation travel when the clutch is applied. The clutch must not "slip" when the hand lever is pulled.

- Give the customer the certificate which must be carried on every ride.

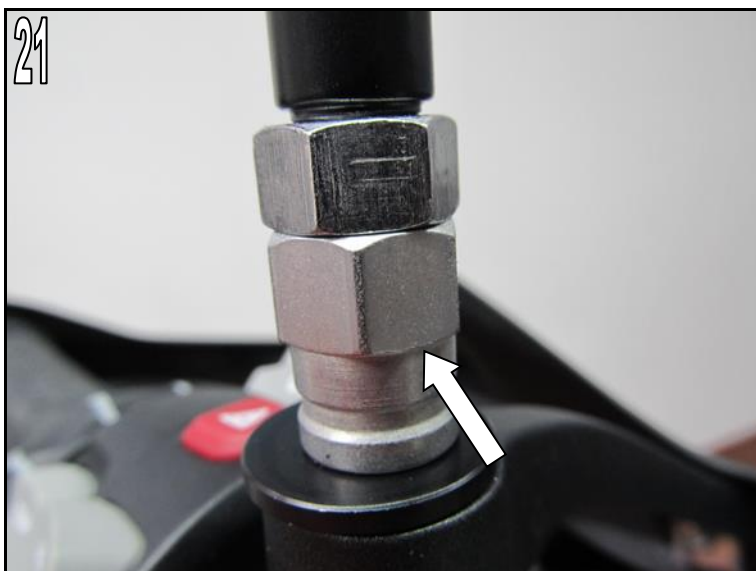

Fitting Instructions Hand Lever Type AC S 2 / Issue: 19.01.2023 / TSch / REV02

AC Schnitzer - Neuenhofstraße 160 - D - 52078 Aachen - Tel. 0241/5688 -300 Fax -135 / [www.ac-schnitzer.de](http://www.ac-schnitzer.de)

# **AC SCHNITZER**

## **-Fitting Instructions-**



## **Hand Lever Type AC S 2**

**on BMW Scrambler**



## AC Schnitzer Hand Lever AC S II

### 2. Fitting

#### - General Notes -

- **Before starting** work, park the vehicle safely and secure against falling or rolling away. (Fig. 1)
- **After completing** the work, carry out a test ride and check that the hand levers and electrical system (clutch switch / brake light switch / GRA switch and lighting system) function properly.
- A general operating licence is supplied with the AC Schnitzer hand lever type ACS2. This must be given to the customer with the information that these documents **must be carried on every ride!**

- The AC Schnitzer hand levers have 6 settings. The current position can be seen from the line marking. (Fig. 2) To adjust, press the hand lever slightly forward (in direction of travel), and turn the adjustment lever clockwise/counter-clockwise as required. AC Schnitzer recommends that adjustments are only performed when parked. In all cases, ensure there is **sufficient remaining travel** on operation. AC Schnitzer bears no liability for damage resulting from incorrect installation and lack of remaining travel!

- Before mounting on the vehicle, install the long or short extension (1 long & 1 short supplied per lever) using the fixing bolts supplied. For this, from the outside insert the desired extension flush into the guide of the lever concerned, and secure with 6 bolts per lever.
- Warning: Do not overtighten bolts! (Fig. 3)



# Fitting Instructions



## AC Schnitzer Hand Lever AC S II

### 2. Fitting

- Release nut below bolt and remove.
- Release bolt counterclockwise with a sufficiently wide screwdriver and remove.
- Remove brake lever from hand fitting. (Fig.1)



- Lubricate shank of fixing bolt but not the thread.
- Place AC Schnitzer brake lever on the vehicle, fit greased fixing bolt, and tighten fully.
- Tightening torque: 1Nm
- Place new nut on fixing bolt from below, and tighten fully.
- Counterhold fixing bolt.
- Tightening torque for nut: 6Nm. (Fig. 5)



- Ensure that the contact point between the hand lever and the pressure piston is adequately lubricated, add grease if required. (Fig. 6)



# Fitting Instructions

**AC  
SCHNITZER**

## AC Schnitzer Hand Lever AC S II

### 2. Fitting

- Release standard fixing nut from below and remove.
- Release bolt counterclockwise with a sufficiently wide screwdriver and remove.
- Remove clutch lever from hand fitting. (Fig. 7)



- Remove bush from clutch lever, clean and grease. (Fig. 8)

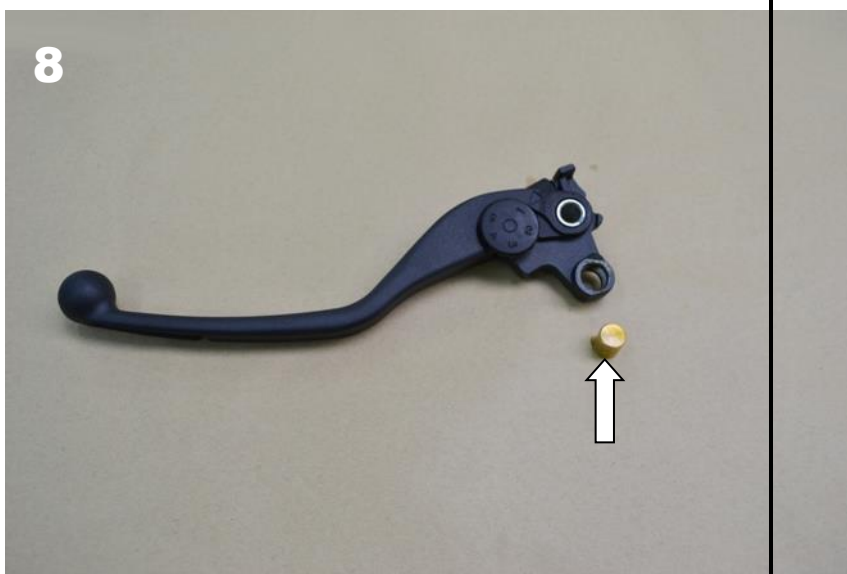

- Insert cleaned and greased bush in AC Schnitzer clutch lever. (Fig. 9)

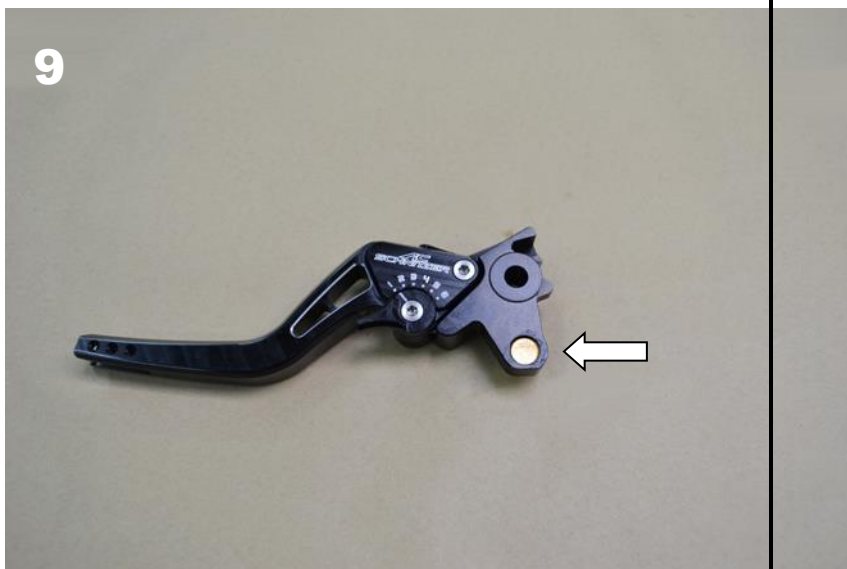



# Fitting Instructions



## AC Schnitzer Hand Lever AC S II

### 2. Fitting

- Place AC Schnitzer clutch lever on fitting.
- Ensure that the pressure piston slides in the bore of the bush.
- Lubricate fixing bolt, insert and tighten fully.
- Tightening torque: 1Nm
- Place new nut on fixing bolt from below, and tighten fully.
- Tightening torque for fixing bolt: 6 Nm

